

Model 670, 690 & 970
 (EM and EMS)
Continuous Flow
Grain Dryers
 47164-52697

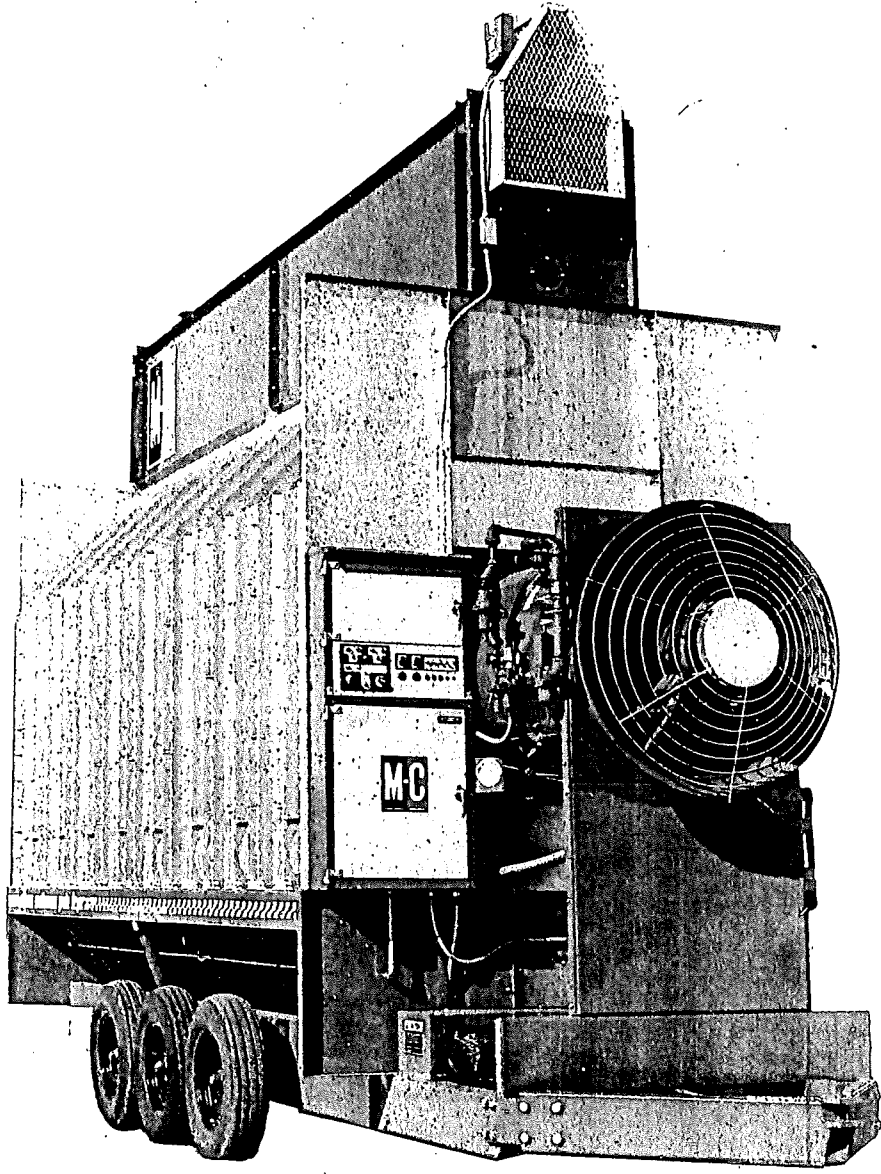

PARTS CATALOG

Form No. D207-1, November 1990
 (Replaces D207 Dated November 1988)

Mathews Company / 500 Industrial Ave., Crystal Lake, IL 60012, U.S.A.
 815/459-2210 FAX: 815/459-5889

CONTENTS

	Page
Introduction	
Parts Ordering Instructions	1
Model and Serial Number Location	1
Capscrew Grade Identification	1
Parts	
Air Pressure Switch	43
Air Stabilizer	17
Air Straighteners	16
Augers	
Level	37 & 38
Unload	2
Belts	
Level Auger	37 & 38
Unload Auger	14
Bin Level Indicator - S/N 48981 & Up	42
Burner	17
Burner Target	16
Cabinets	
115 V Control Cabinet - 970 Below S/N 47164	27
115 V Control Cabinet - 670, 690 & 970 Above S/N 47163	30
Motor Control Cabinet - 970 Below S/N 47164	28
Motor Control Cabinet - 670, 690 and 970 Above S/N 47163	30
Circuit Breakers - Level Auger, Unload Auger and Fan Motor	46
Coils	
Magnetic Starter - 115V	47
1¼" Solenoid Valve	25
½" Solenoid Valve	23
Contacts - For Magnetic Starters	47
Control Panel Lights, Switches and Controls	34
Decal Kit - All Models	50
Electrical Components in 115V Control Cabinet	32
Electrode	21
End Panels	
670 and 970	10
690	13
Fans	18
Fan Motors	45 & 46
Fan Motor Mount	18
Fan Orifice	16
Fan Orifice Supports	19
Flame Sensing Probe	21
Floor Panels - 670 and 970	10
Guards	
Fan	19
Level Auger Motor	37 & 38
SCR Drive	15

Continued on next page.

	Page
High Limit Switch	36
Hopper	
Below S/N 48981	37
S/N 48981 and Up	38
Ignition Board	32
Ignition Wires	21
Interlocks - For Magnetic Starters	47
Jumper Straps - For Magnetic Starters	47
Kits - Field Installed	50
Level Auger	
Below S/N 48981	37
S/N 48981 and Up	38
Belts	37 & 38
Motor	45 & 46
Motor Mount - Below S/N 48981	45
Switch Assembly	
Below S/N 48981 (Mercury Switch)	42
S/N 48981 and Up (Bin Level Indicator)	42
Lights, Control Panel	34
LP Gas Liquid Line Piping	23
LP Gas Manifold and Piping	24
Magnetic Starters	46
Manifolds	
LP Gas	24
Natural Gas	25
Mercury Switch	4 & 42
Metering Rolls	2
Mixing Chamber	16
Modulating Valves	24 & 25
Modulating Valve Power Elements	24 & 25
Modulating Valve Repair Kits	26
Moisture Control	
Below S/N 51559 (Fenwal)	43
S/N 51559 and Up (Zytron)	
Potentiometer	35
Moisture Control	33
Thermistor Sensor	43
Motors	45 & 46
Natural Gas Manifold and Piping	25
Orifice Liners	16
Portabilities	49
Pressure Gauge (Gas)	24 & 25
Pressure Regulator (LP Gas)	24
Pressure Regulator (LP Gas) Repair Kit	26
Relays	32
Relief Valve - LP Gas	23

	Page
SCR Drive Unload System	
Control Board	32
Motor and Gear Box	14
Potentiometer	34
Screens	
Base Screens	7
Upper Screens	8
Solenoid Valves	
1¼" - LP Gas and Natural Gas	24 & 25
½" - LP Gas	23
Solenoid Valve Repair Kits	26
Switches, Control Panel	34
Tank Valve - LP Gas	23
Terminal Tracks	32
Thermistor - S/N 51559 and Up	43
Thermometer	
970 Below S/N 47164	35
670, 690 and 970 S/N 47164 and Up	30
Timers	
10 Second - Ignition - S/N 47164 and Up	32 & 33
2 to 8 Minute Adjustable - Level Auger - S/N 48981 and Up	33
1 Minute - Level Auger - Below S/N 48981	32
30 Minute - Level Auger - S/N 48981 and Up	33
60 Minute Adjustable - Low Grain Level	32 & 33
Transformers	30
Unload Auger	
Auger	2
Belts	14
Extension Kit (2 ft.)	48
Motor	45 & 46
Pans	6
Vaporizer Coil - LP Gas	17

NOTES

INTRODUCTION

Parts Ordering Instructions

1. Order parts from your local M-C Dealer or distributor.
2. Always furnish the Grain Dryer model and serial number. This information is stamped on the serial number plate.
3. When ordering parts be sure to furnish the part number, description and quantity required.

NOTE: Attaching hardware is listed (but not included) with the main part. It must be ordered separately.

4. Inspect all shipments upon receipt. If any packages and/or boxes are missing, or parts are damaged, file a claim with the carrier immediately. Failure to do so may void a claim. Check the shipment against the packing list carefully. Report any shortages to the shipper immediately.
5. Do not return any parts to the Mathews Company without a "Return Goods Authorization" from the factory. All return parts shipments must be shipped prepaid (COD shipments will not be accepted). Shipments must also include the following:
 - A. A letter of explanation including the "Return Goods Authorization Number," your name and address.
 - B. A list of all parts being returned. List must include part numbers, description, quantity, and original invoice number.

Model and Serial Number Location

The model and serial number of your Grain Dryer are stamped on a plate located on the left front end

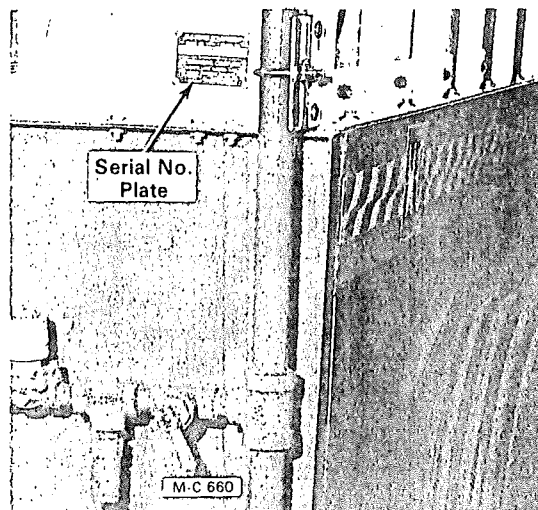

Figure 1

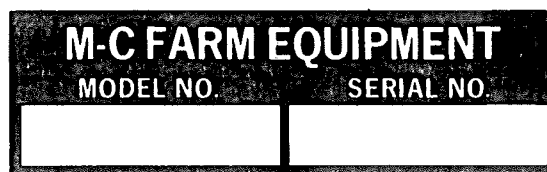

Figure 2

panel, see Figure 1. On late production dryers, the plate is on the dryer front base panel just below the location shown in Figure 1. Record the model and serial number in the blank spaces in Figure 2.

Capscrew Grade Identification

There are four grades of hex-head capscrews. Grade 1 and 2 are common capscrews, grade 5 and 8 are used when greater strength is required. Each grade can be identified by the marking on the head of the capscrew, see chart below.

When replacing capscrews, be sure to use the correct size and grade. If a specific grade is not shown as part of the description, the capscrew is a grade 1 or 2.

CAPSCREW GRADE IDENTIFICATION CHART

S.A.E. Grade	Description	Capscrew Head Marking*
1	WILL HAVE A PLAIN HEAD - NO RADIAL LINES	
2	Low or Medium Carbon Steel Not Heat Treated	
5	WILL HAVE 3 RADIAL LINES Quenched and Tempered Medium Carbon Steel	
8	WILL HAVE 6 RADIAL LINES Quenched and Tempered Special Carbon or Alloy Steel	

*The center marking identifies the capscrew manufacturer.

Metering Rolls and Unload Auger

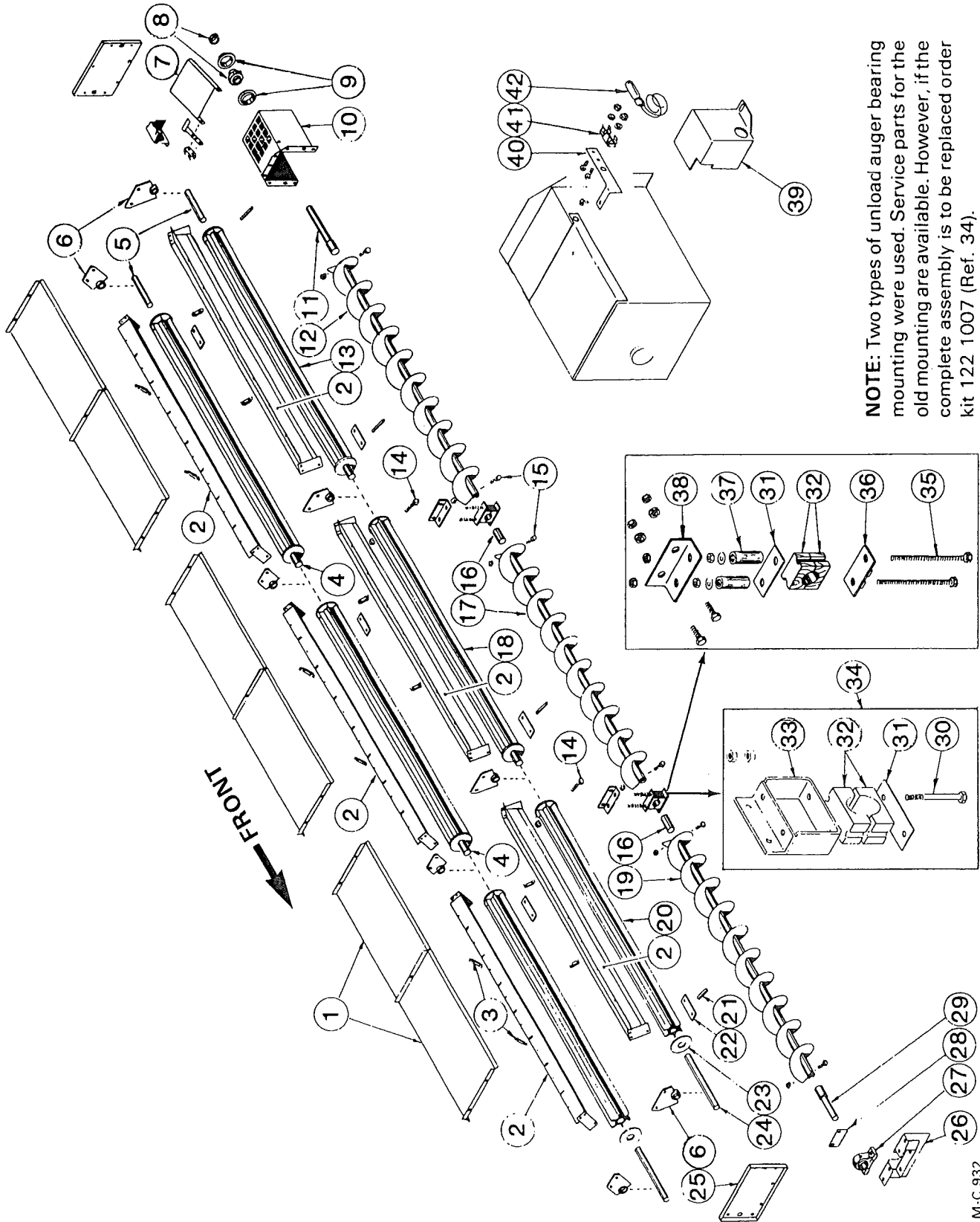

NOTE: Two types of unload auger bearing mounting were used. Service parts for the old mounting are available. However, if the complete assembly is to be replaced order kit 122 1007 (Ref. 34).

Metering Rolls and Unload Auger

Ref.	Part No.	Qty. (16')	Qty. (24')	Description
1	128 2890	4	6	Unload Auger Cover
	001 8111	8	12	5/16-18 Clip Nut
	000 8106	12	21	5/16-18 x 3/4" Capscrew
	000 8173	12	21	5/16" Flatwasher
	000 8169	4	9	5/16-18 Flanged Locknut
2	128 0225	4	6	Inner Perf. Mt. Weld
	000 8106	18	24	5/16-18 x 3/4" Capscrew
	000 8169	18	24	5/16-18 Flanged Locknut
3	128 8958	8	12	Support Rod (3/8" x 4 3/8")
	000 8173	8	12	5/16" Flatwasher
	000 8168	24	36	3/8-16 Flanged Locknut
4	121 5043	2	4	Rear & Center Metering Roll Shaft-1 1/4x7" (press fit in metering roll)
5	121 5042	2	2	Rear Metering Roll Stub Shaft - 1 1/4"x5" (press fit in metering roll)
6	128 1063	6	8	Metering Roll Brg. w/Bronze Bushing
	000 8106	12	16	5/16-18 x 3/4" Capscrew
	000 8169	12	16	5/16-18 Flanged Locknut
7	128 4712	1	1	Over Load Door
	000 8119	2	2	3/8-16 x 3/4" Capscrew
	000 8205	2	2	3/8-16 Top Lock Flanged Nut
8	001 6003	1	1	1 1/4" Bearing w/Lock Collar
9	001 6004	2	2	1 1/4" Bearing Flangette
	000 8121	3	3	3/8-16 x 1" Capscrew
	000 8168	3	3	3/8-16 Flanged Locknut
10	128 0096	—	1	Unload Auger Discharge Below S/N 47164 (For 8" auger)
	128 0242	1	1	Unload Auger Discharge Above S/N 47163 (For 10" auger)
	000 8106	9	9	5/16-18 x 3/4" Capscrew
	000 8169	9	9	5/16-18 Flanged Locknut

Ref.	Part No.	Qty. (16')	Qty. (24')	Description
11	128 5998	1	1	Unload Auger Output Shaft
12	128 0074	—	1	Rear Unload Auger (8") Below S/N 47164
	128 0245	1	1	Rear Unload Auger (10") Above S/N 47163
13	121 1082	2	2	Rear Metering Roll Ass'y. (incl. shafts)
14	000 8114	2	4	5/16-18 x 2 1/2" Capscrew
	000 8222	2	4	5/16" Lockwasher
	000 8159	2	4	5/16-18 Hex Nut
15	000 8229	8	12	3/8-16 x 2 3/4" Capscrew-Grd. 5
	000 8205	8	12	Top-Lock Flange Nut
16	128 5618	1	2	Unload Auger Link
17	128 0073	—	1	Center Unload Auger (8") Below S/N 47164
	128 0244	—	1	Center Unload Auger (10") Above S/N 47163
18	121 1083	—	2	Center Metering Roll Ass'y. (incl. shaft)
19	128 0189	—	1	Front Unload Auger (8") Below S/N 47164
	128 0243	1	1	Front Unload Auger (10") Above S/N 47163
20	128 1254	2	2	Front Metering Roll Ass'y. (incl. shaft)
21	000 8259	3	4	Roll Pin 5/16" x 1 3/4"
22	121 2637	4	6	Clean-Out Cover
	000 8168	8	12	3/8-16 Flanged Locknut
23	121 4438	AR	AR	Metering Roll Washer-11 Gauge
	128 4970	AR	AR	Metering Roll Washer-16 Gauge
24	128 5042	2	2	Front Metering Roll Shaft - 1 1/4" x 13 1/4" (press fit in metering roll)

Metering Rolls and Unload Auger

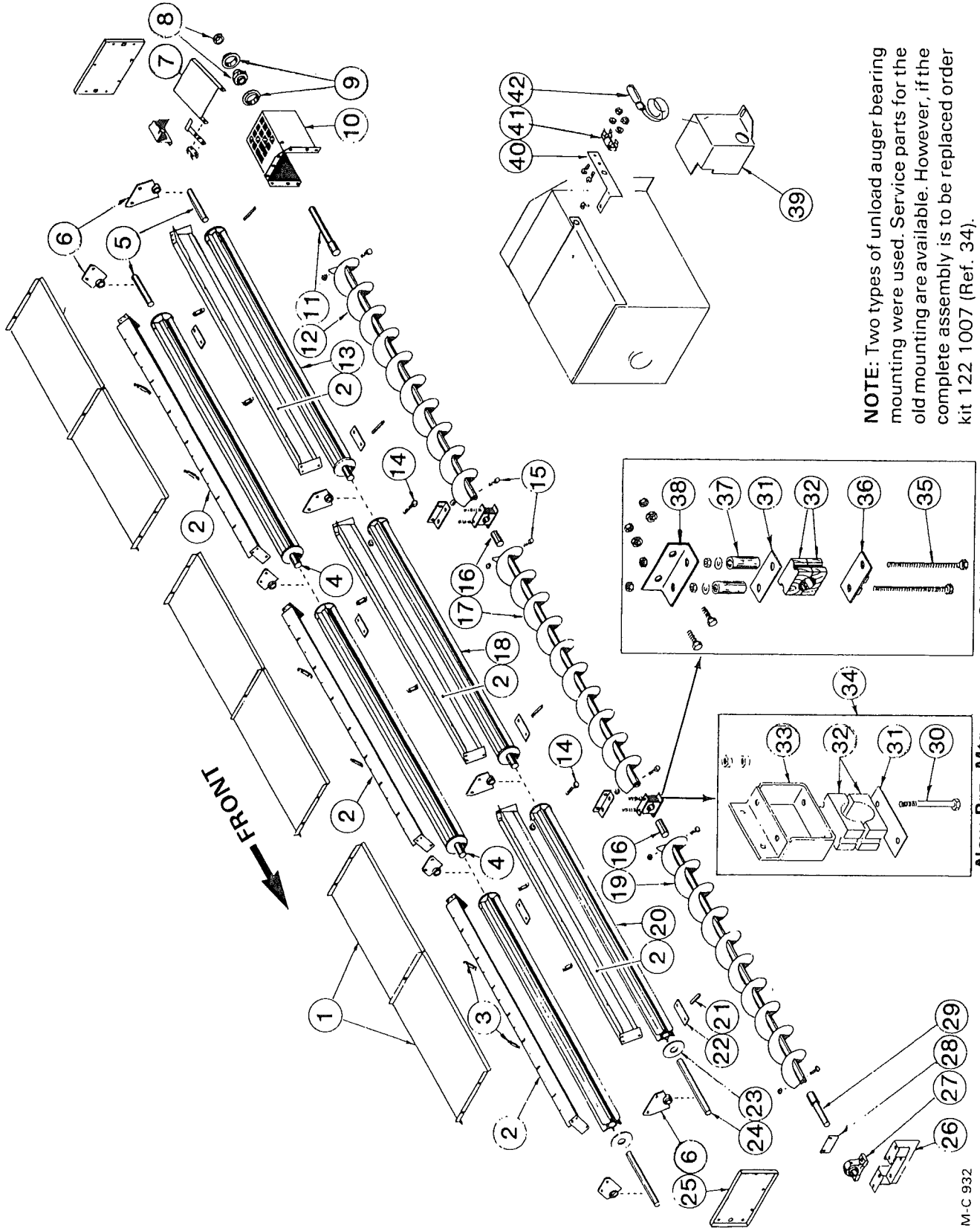

NOTE: Two types of unload auger bearing mounting were used. Service parts for the old mounting are available. However, if the complete assembly is to be replaced order kit 122 1007 (Ref. 34).

M-C 932

Metering Rolls and Unload Auger

Ref.	Part No.	Qty. (16')	Qty. (24')	Description	Ref.	Part No.	Qty. (16')	Qty. (24')	Description
25	128 2894	1	1	Base Panel Access Door- 17 1/2" x 10 1/2" (2 on 690 before 1989 - See note)	32	128 6020	1	2	Wood Brg. 1-5/16" (2 Halves)
26	001 8284	14	14	5/16-12 x 1/2" Self Tapping Screw	33	128 0287	1	2	Unload Auger Brg. Brkt.
	128 0075	—	1	Unload Auger Front Plate - Below S/N 47164 (For 8" auger)	34	122 1007	1	2	Unload Auger Brg. Kit (Incl. ref. 30 thru 33 in quantities reqd. for one brg.)
	128 0247	1	1	Unload Auger Front Plate Above S/N 47163 (For 10" auger)	35	041 8160	2	4	1/2-13 x 8" Full Thread Capscrew- Grd. 8
	000 8119	4	4	3/8-16 x 3/4" Capscrew		000 8163	4	8	1/2-13 Hex Nut
	000 8168	4	4	3/8-16 Flanged Locknut		000 8180	2	4	1/2" Lockwasher
27	001 6011	1	1	1-7/16" Bore Pillow Block Brg.	36	128 0285	1	2	Unload Auger Brg. Support
	001 8299	2	2	1/2-13 x 1 3/4" Capscrew-Grd. 8 w/Nylock	37	128 5575	2	4	Spacer-1/2" x 3-3/16"
	001 8257	2	2	1/2" SAE Flatwasher	38	128 3932	1	2	Unload Auger Brg. Hanger Brkt.
	000 8163	2	2	1/2-13 Hex Nut		000 8137	2	4	1/2-13 x 1 1/4" Capscrew - Grd. 5
28	128 3008	1	1	Front Seal Plate		000 8180	2	4	1/2" Lockwasher
	000 8184	4	4	8-18 x 1/2" Sheet Metal Screw	39	128 4896	1	1	1/2-13 Hex Nut
29	128 5996	1	1	Unload Auger Input Shaft		128 4896	1	1	Shut-Off Switch Cover
30	001 8168	2	4	1/2-13 x 4 1/2" Capscrew - Grd. 5	40	001 8284	2	2	5/16-12 x 1/2" Self-Tapping Screw
	000 8180	2	4	1/2" Lockwasher	41	120 2937	1	1	Bulb Mount
	000 8163	4	8	1/2-13 Hex Nut		120 6801	1	1	Mercury Switch Mt. Clip
31	128 4250	1	2	Unload Auger Mid Brg. Support		000 8282	2	2	6-32 x 1/4" Machine Screw
					42	000 8185	2	2	6-32 Flanged Locknut
						120 6800	1	1	Mercury Switch

NOTE: Starting in 1989, the Model 690 has Base Filler Panel
128 4570 (37" x 13 1/2") at the front of the dryer in place of the Base
Panel Access Door.

Unload Auger Pans

Quick Clean Unload Auger Pans - Above S/N 47163

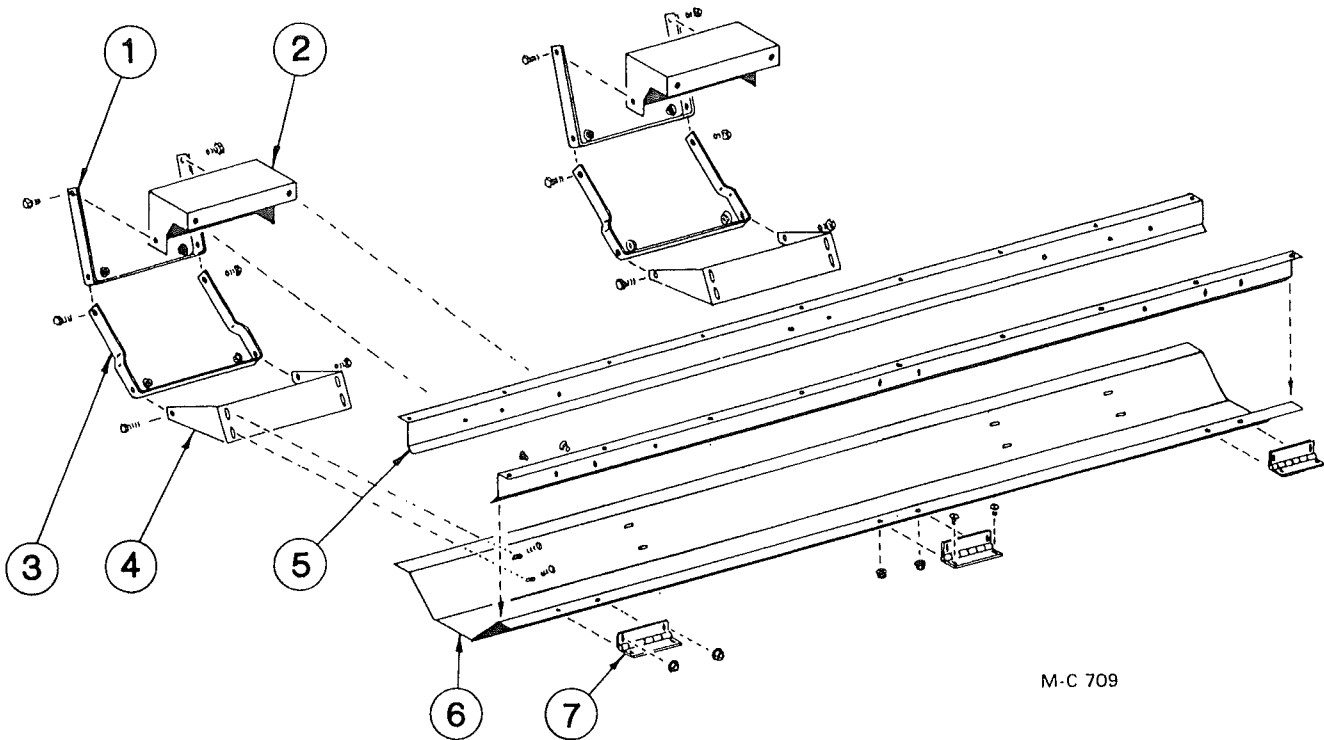

M-C 709

Unload Auger Pans - Below S/N 47164

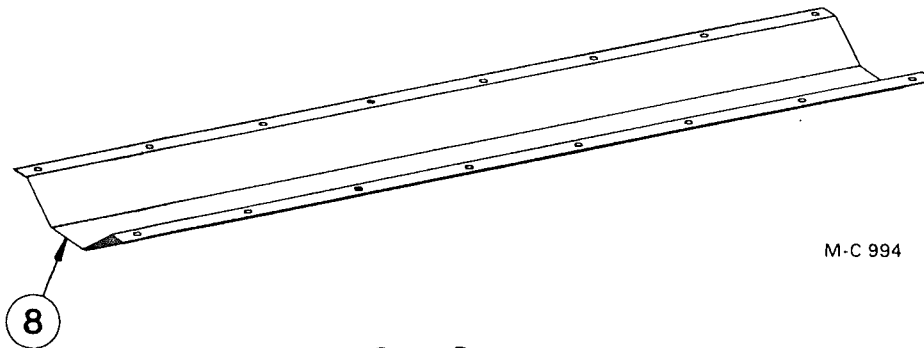

M-C 994

Ref.	Part No.	Qty. (16')	Qty. (24')	Description
1	128 2029	4	6	Auger Dump Arm Upper
2	128 2750	4	6	Upper Link Pivot Base
3	128 2030	4	6	Auger Dump Arm Lower
4	128 2751	4	6	Bottom Link Pivot Base
5	128 2673	4	6	Pan Hinge Angle
6	128 2752	2	3	Auger Dump Pan
7	128 8957	6	9	Hinge
7A	128 8355	4	6	Warning Decal (not shown)
8	128 2733	—	3	Unload Auger Pan

Base Screens

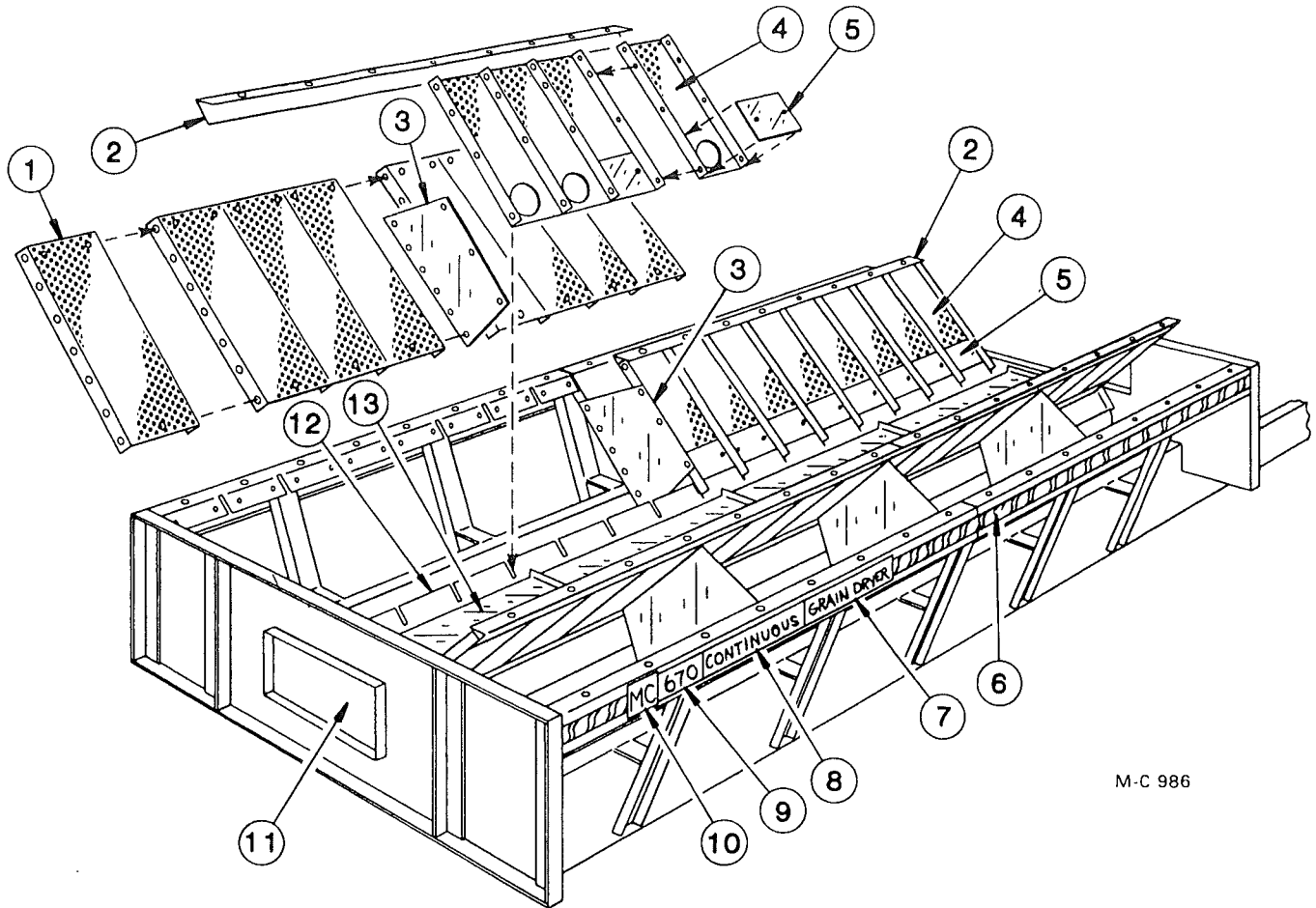

M-C 986

Ref. Part No.	Qty. (16')	Qty. (24')	Description	Ref. Part No.	Qty. (16')	Qty. (24')	Description
1	---	---	Lower Outer Screen	10	128 8300	2	M-C Decal -
	128 2951	32	Galvanized (Std.)				5" x 4-9/16"
	127 2945	32	Small Seed (Galv.)	11	128 2894	1	Base Panel Access
2	128 2739	4	Lower Screen Mt. Angle				Door (2 on 690
3	128 2855	6	Lower Screen Stiffener				before 1989 -
4	---	---	Lower Inner Screen				See note 2)
			w/Clean-Out (See note 1)	001 8284	7	7	5/16 - 12 x 1/2" Self
	128 2994	32	Galvanized (Std.)				Tapping Screw
	127 2960	32	Small Seed (Galv.)	12	128 0225	4	6
5	128 2995	32	Lower Inner Screen				Inner Perf. Mt. Weld
			Cover	000 8106	18	24	5/16 - 18 x 3/4" Capscrew
6	128 8310	24 ft.	Red & Yellow Stripe	000 8169	18	24	5/16 - 18 Flanged
		39 ft.	Decal - 2 1/2"				Locknut
7	128 8309	2	"Grain Dryer" Decal	13	128 2890	4	6
8	128 8308	2	"Continuous" Decal				Unload Auger Cover
9	128 8361	2	"670" Base Decal	001 8111	8	12	5/16 - 18 Clip Nut
	128 8367	2	"690" Base Decal	000 8106	12	21	5/16 - 18 x 3/4"
	128 8362	---	"970" Base Decal				Capscrew
				000 8173	12	21	5/16" Flatwasher
				000 8169	4	9	5/16 - 18 Flanged
							Locknut

NOTE 1: Screen w/o clean-out is no longer available. Order Galvanized (Std.) Screen Ass'y. 124 1032 or Small Seed (Galv.) Screen Ass'y. 124 1033. Assemblies include ref. 4 screen, ref. 5 cover and cover attaching hardware.

NOTE 2: Starting in 1989, the Model 690 used Base Filler Panel 128 4570 (37" x 13 1/2") at the front of the dryer.

Upper Screens

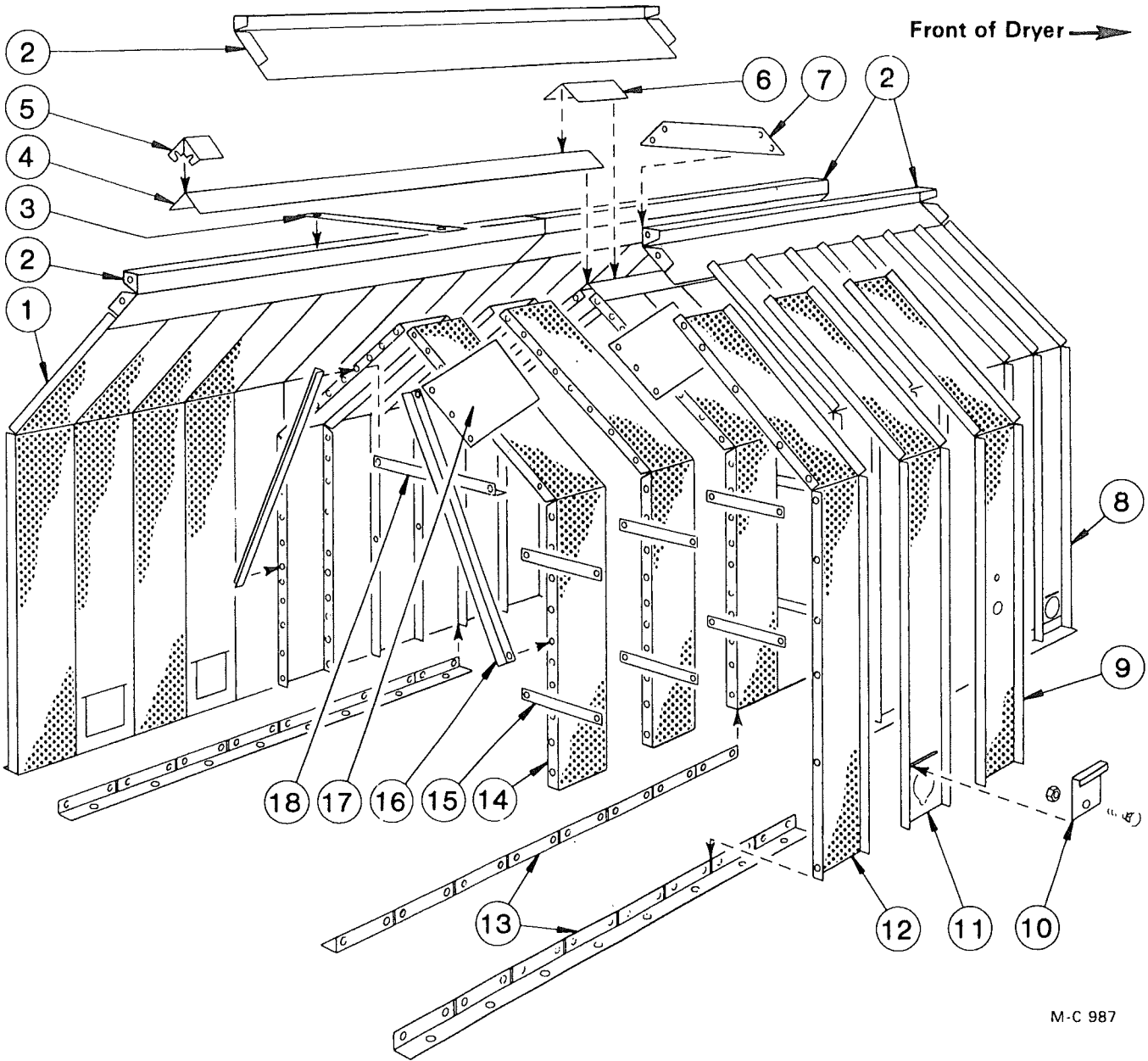

M-C 987

Ref. Part No.	Qty. (16')	Qty. (24')	Description
1	---	---	Outer End Screen w/o Quick Drain
021 2946	2	2	Galvanized (Std.)
127 2967	2	2	Small Seed (Galv.)
123 5213	2	2	Aluminum
2 129 4949	4	6	Hopper Joiner Angle - Above S/N 48980
128 2934	4	6	Hopper Joiner Panel - Below S/N 48981

Ref. Part No.	Qty. (16')	Qty. (24')	Description
3 129 2947	2	3	Stiffener Strap - Above S/N 48980
4 021 2950	2	3	Hopper Cap
5 128 2908	2	2	Peak Seal Angle - Below S/N 48981
6 128 3075	1	2	Seal Angle - Above S/N 48980
7 129 2831	1	2	Joiner Plate - Above S/N 48980
128 2935	1	2	Joiner Plate - Below S/N 48981

Upper Screens

Ref.	Part No.	Qty. (16')	Qty. (24')	Description	Ref.	Part No.	Qty. (16')	Qty. (24')	Description
8	---	---	---	Outer End Screen w/Quick Drain	12	---	---	---	Outer Screen w/o Quick Drain
	128 3002	2	2	Galvanized (Std.)		021 2945	†13	21	Galvanized (Std.)
	127 2963	2	2	Small Seed (Galv.)		127 2964	†13	21	Small Seed (Galv.)
	123 5210	2	2	Aluminum		123 5211	†13	21	Aluminum
9	---	---	---	Moisture Control Screen	13	125 2732	8	12	Screen Mount Angle
	021 2947	★1	1	Galvanized (Std.)	14	---	---	---	Inner Screen
	127 2966	★1	1	Small Seed (Galv.)		021 2949	32	48	Galvanized (Std.)
	123 5214	★1	1	Aluminum		127 2968	32	48	Small Seed (Galv.)
10	---	---	---	Quick Drain Door	15	121 3007	60	92	Stiffener Strap
	127 2950	16	24	Galvanized (Std.)	16	128 2663	14	22	Inner Brace
	127 2974	16	24	Small Seed (Galv.)	17	128 3072	14	22	Peak Screen Stiffener
	001 8269	16	24	3/8 - 16 x 3/4" Carriage Bolt	18	021 2600	7	11	Inner Cross Tie
	000 8168	16	24	3/8 - 16 Flanged Locknut					
11	---	---	---	Outer Screen w/Quick Drain					
	128 3001	14	22	Galvanized (Std.)					
	127 2965	14	22	Small Seed (Galv.)					
	123 5212	14	22	Aluminum					

† 14 used on 690 below S/N 51559

★ Not used on 690 below S/N 51559

End Panels and Floor Panels (Model 670 & 970)

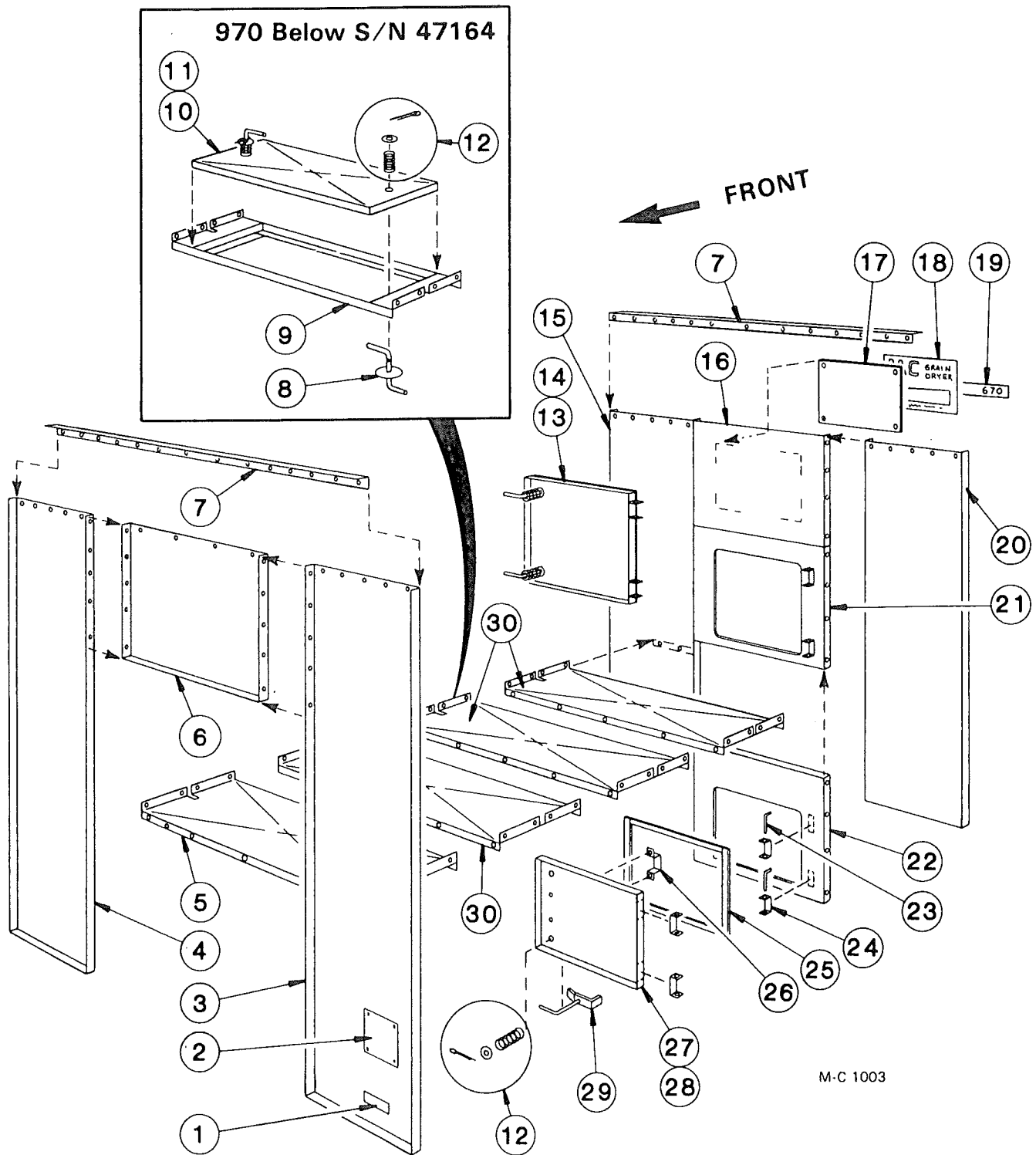

M-C 1003

End Panels and Floor Panels

(Model 670 & 970)

Ref.	Part No.	Qty.		Description	Ref.	Part No.	Qty.		Description
		670	970				670	970	
1	121 8310	1	1	"Made in USA" - Decal	14	128 2957	1	1	Upper Rear Door Panel
2	127 8300	1	1	"CGA" Dryer Plate (Canada only)	15	021 2832	1	1	Right Rear End Panel
3	124 2836	1	1	Left Front Panel - Above S/N 47163	16	128 2919	1	1	Panel Above Door
	021 2831	—	1	Left Front Panel - Below S/N 47164	17	128 2999	1	1	Decal Mount Plate
4	124 2835	1	1	Right Front Panel - Above S/N 47163	18	128 8331	1	1	Large Decal - See note
	128 2929	—	1	Right Front Panel - Below S/N 47164	19	128 8359	1	—	670 Model Decal
5	128 2920	1	1	Front Unit Floor Panel		128 8360	—	1	970 Model Decal
6	128 2921	1	1	Panel Above Fan	20	021 2833	1	1	Left Rear End Panel
7	021 2602	2	2	End Panel to Hopper Joiner Angle	21	128 2715	1	1	Upper Door Frame
8	121 0302	—	2	Latch and Handle	22	128 2753	1	1	Lower Door Frame
9	121 0299	—	1	Heat Chamber Door Frame	23	128 5201	4	4	Hinge Pin
10	121 1113	—	1	Heat Chamber Door Ass'y. (Incl. ref. 8, 11 & 12)	24	128 2740	8	8	Door Hinge
11	121 2970	—	1	Heat Chamber Door Panel		000 8212	16	16	¼ - 20 x ½" Truss Hd. Screw
12	001 8256	—	—	Spring - ⅝" ID x 2"		000 8167	16	16	¼ - 20 Flanged Locknut
	000 8174	—	—	⅜" Flatwasher	25	121 8966	—	—	Weather Stripping (Order ft. reqd.)
	000 8199	—	—	⅛" x 1" Cotter Pin	26	121 2887	2	2	Door Handle
13	128 1183	1	1	Upper Rear Door Ass'y. (Incl. ref. 12, 14, 24, 25, 26 & 29)	27	128 1902	1	1	Lower Rear Door Ass'y. (Incl. ref. 12, 24, 25, 26, 28 & 29)
					28	128 3006	1	1	Lower Door Rear Panel
					29	121 0414	4	4	Latch and Handle
					30	121 2928	7	11	Unit Floor Panel (10 used on 970 below S/N 47164)

NOTE: This decal is imprinted "Model 975." Order one of ref. 19 to be placed over "Model 975."

This page intentionally blank.

End Panels

(Model 690)

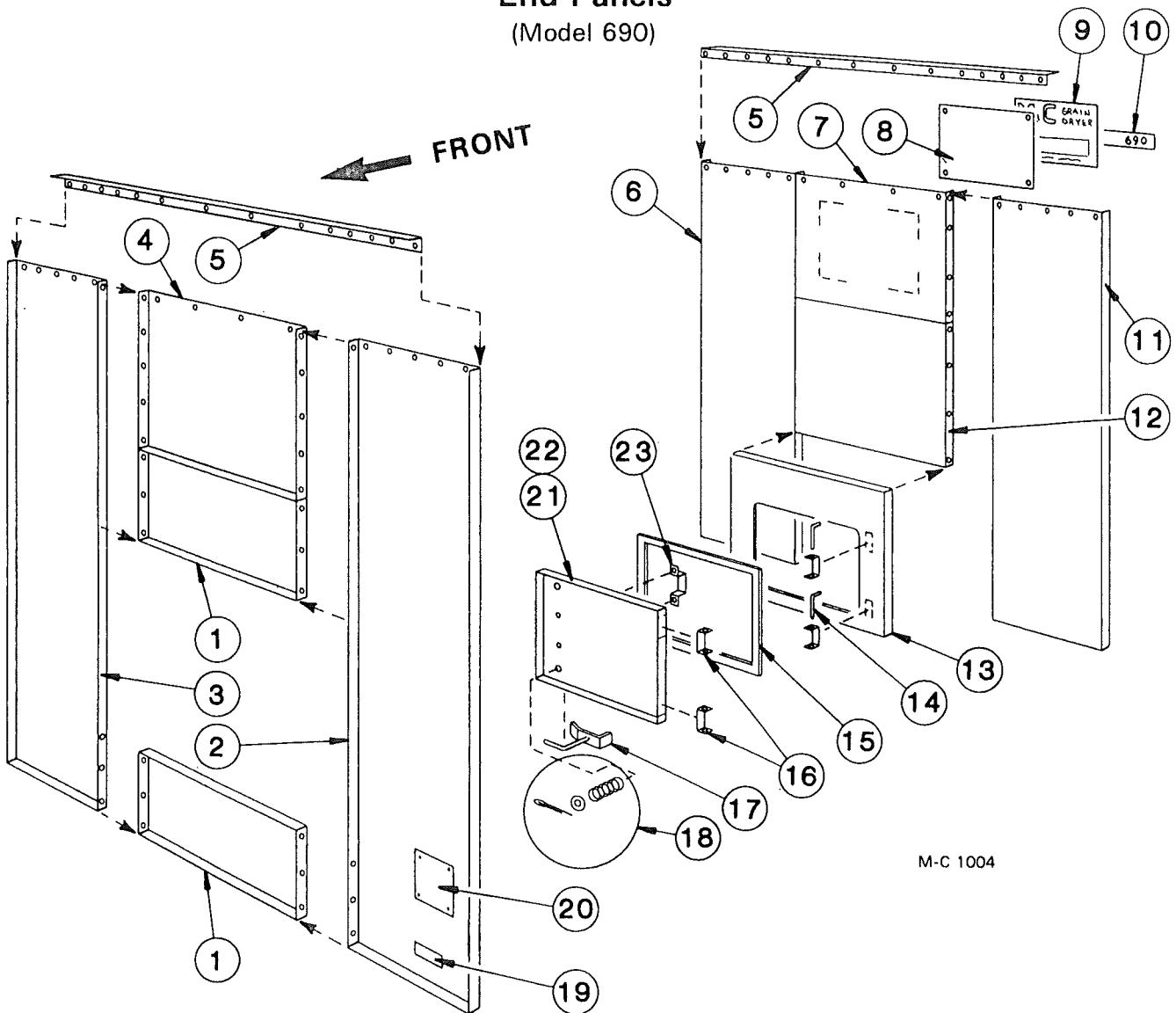

M-C 1004

Ref.	Part No.	Qty.	Description	Ref.	Part No.	Qty.	Description
1	128 4969	2	Spacer Panel	15	121 8966	—	Weather Stripping (Order ft. reqd.)
2	124 2836	1	Left Front Panel	16	128 2740	4	Door Hinge
3	124 2835	1	Right Front Panel		000 8212	8	¼ - 20 x ½" Truss Hd. Screw
4	128 2921	1	Panel Above Fan		000 8167	8	¼ - 20 Flanged Locknut
5	021 2602	2	End Panel to Hopper Joiner Angle	17	121 0414	2	Latch and Handle
6	021 2832	1	Right Rear End Panel	18	001 8256	2	Spring - ⅝" ID x 2"
7	128 2919	1	Panel Above Door (37" x 30")		000 8174	4	⅜" Flatwasher
8	128 2999	1	Decal Mount Plate		000 8199	2	⅛" x 1" Cotter Pin
9	128 8331	1	Large Decal - See note	19	121 8310	1	"Made in USA" - Decal
10	128 8368	1	690 Model Decal	20	127 8300	1	"CGA" Dryer Plate (Canada only)
11	021 2833	1	Left Rear End Panel	21	128 1183	1	Rear Door Ass'y. (Incl. ref. 15 thru 18, 22, & 23)
12	128 2888	1	Filler Panel (37" x 33")	22	128 2957	1	Rear Door Panel
13	128 2715	1	Door Frame	23	121 2887	1	Door Handle
14	128 5201	2	Hinge Pin				

NOTE: This decal is imprinted "Model 975." Order ref. 10 to be placed over "Model 975."

SCR Drive Motor and Gear Box

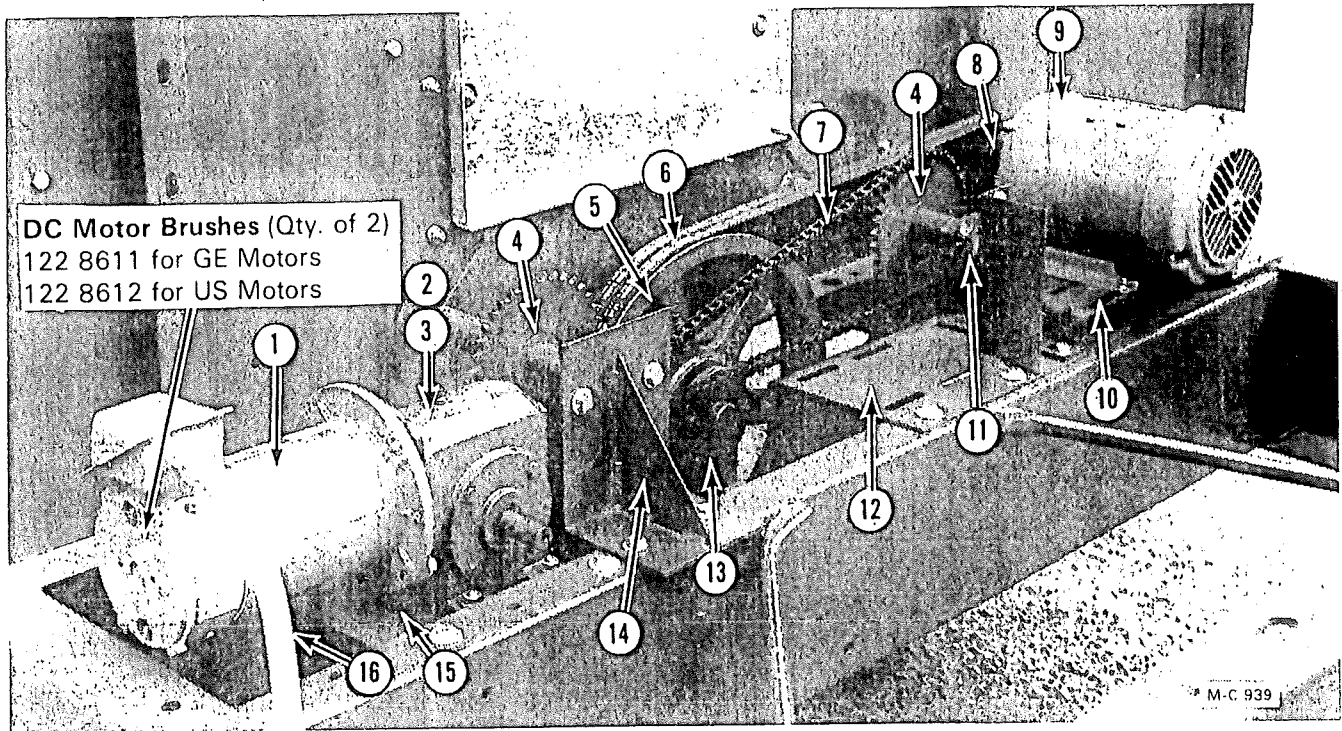

Ref.	Part No.	Qty.	Description	Ref.	Part No.	Qty.	Description
1	124 6837	1	DC Motor - 1/3 HP	8	121 6210	1	Pulley-2B - 3-3/16" OD- 5/8" Bore
	122 8611	1	Brushes for GE Motors (Incl. 2 brushes)		121 6203	1	Pulley-2B - 3-3/16" OD- 7/8" Bore
	122 8612	1	Brushes for US Motors (Incl. 2 brushes)	9	---	1	Unload Auger Motor (See page 45 thru 47)
2	124 6624	1	SCR Gear Box (Incl. 3/16" x 1" Key-001 5110)	001 5112	1	Key - 3/16" x 1 3/8" (For 1 1/2 HP motor)	
	128 8947	1	Pint of Mobil SHC 634 Oil	001 5114	1	Key - 3/16" x 1 5/8" (For 2 HP motor)	
	000 8123	4	3/8-16 x 1 1/4" Capscrew	128 1643	1	Motor to Cabinet Wire Ass'y.	
	000 8174	4	3/8" Flatwasher	000 8110	1	5/16-18 x 1 1/2" Capscrew	
	000 8168	4	3/8" Flanged Locknut	000 8108	3	5/16-18 x 1" Capscrew - Grd. 5	
3	128 6422	1	SCR Gear Box Sprocket (not shown) RC-40 12T, 3/4" Bore	000 8173	8	5/16" Flatwasher	
4	128 6423	2	Sprocket-RC40-36T-1 1/4" Bore (Above S/N 47163)	000 8169	4	5/16-18 Flanged Locknut	
	128 6413	2	Sprocket-RC40-24T-1 1/4" Bore (Below S/N 47164)	10	124 4214	1	Unload Auger Motor Mt.
	000 8298	2	Woodruff Key - 1/4" x 3/4"	000 8121	4	3/8-16 x 1" Capscrew	
5	021 6201	1	Pulley-2B x 13.6 SK	000 8132	1	3/8-16 x 4" "J" Bolt	
	001 5130	1	Key - 3/8" x 1"	000 8174	5	3/8" Flatwasher	
6	021 6100	1	B-65 Belts (Matched set of 2)	000 8168	5	3/8-16 Flanged Locknut	
7	128 6315	1	Chain - RC-40 x 130 Pitch	11	121 6022	2	1 1/4" Outboard Brg.
	002 6309	—	Connecting Link	000 8121	4	3/8-16 x 1" Capscrew	
				000 8174	4	3/8" Flatwasher	
				000 8168	4	3/8-16 Flanged Locknut	

Continued on next page

SCR Drive Motor and Gear Box

Ref.	Part No.	Qty.	Description
12	128 0257	1	Gear Mt. Motor Weld.
	000 8119	4	3/8-16 x 3/4" Capscrew
	000 8174	4	3/8" Flatwasher
	000 8168	4	3/8-16 Flanged Locknut
13	001 6202	1	SK Bushing - 1-7/16" Bore (Incl. capscrews)
14	128 0191	1	Outboard Bearing Mount
15	124 4456	1	Gear Box Mount (Above S/N 48980)
	128 0257	1	Gear Box Mount (Below S/N 48981)
	000 8119	4	3/8-16 x 3/4" Capscrew
	000 8174	4	3/8" Flatwasher
	000 8168	4	3/8-16 Flanged Locknut
16	128 1999	1	SCR Motor to Cabinet Flexible Conduit (40")
17	128 0268	1	Drive Guard
	128 8951	2	Rubber Strap w/Hook
	001 3302	2	Angle Clip
	000 8121	4	3/8 - 16 x 1" Capscrew
	000 8174	6	3/8" Flatwasher
	000 8149	4	3/8 - 16 Two-Way Locknut
18	000 8301	2	Safety Shield Warning Decal

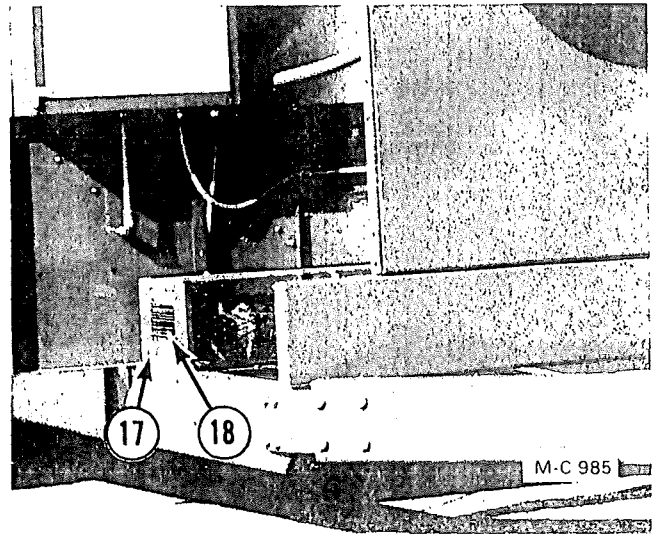

Not Shown

—	120 6914	1	Chase Nipple - 1/2"
—	121 6906	2	Pipe Clamp
	000 8212	2	1/4-20 x 1/2" Truss Hd. Screw
	000 8167	2	1/4-20 Flanged Locknut

Fan Orifice, Orifice Liners, Burner Target, Mixing Chamber and Air Straighteners

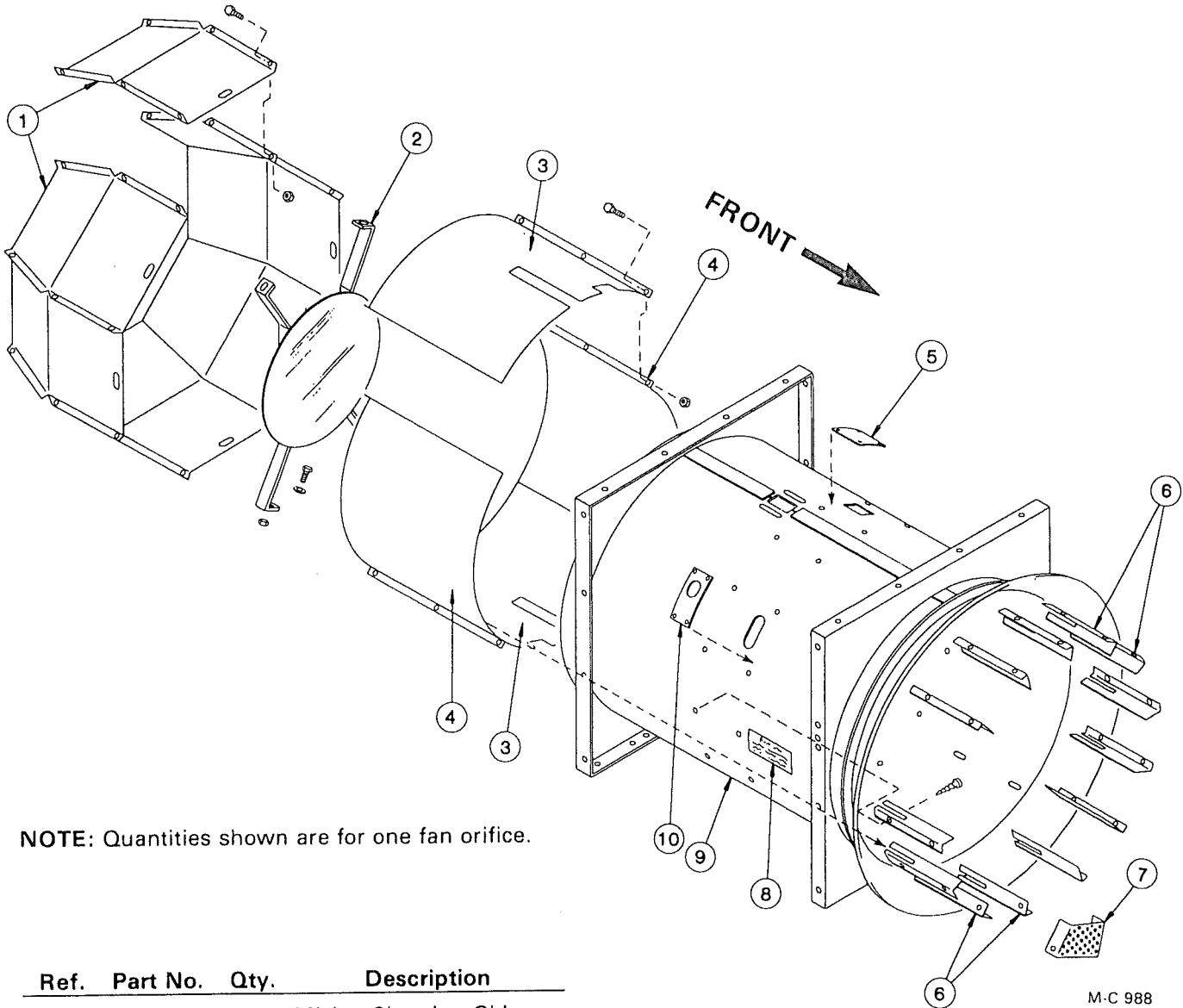

NOTE: Quantities shown are for one fan orifice.

M-C 988

Ref.	Part No.	Qty.	Description
1	128 3074	8	Mixing Chamber Side
	000 8238	27	5/16 - 18 x 1/2" Capscrew
	000 8169	27	5/16 - 18 Flanged Locknut
2	128 0280	1	Burner Target
	000 8108	4	5/16 - 18 x 1" Capscrew - Grd. 5
	000 8173	4	5/16" Flatwasher
	000 8169	4	5/16 - 18 Flanged Locknut
3	124 2830	2	Orifice Liner
	000 8238	12	5/16 - 18 x 1/2" Capscrew
	000 8169	12	5/16 - 18 Flanged Locknut
4	123 5205	2	Orifice Liner
	000 8238	12	5/16 - 18 x 1/2" Capscrew
	000 8169	12	5/16 - 18 Flanged Locknut
5	121 2978	1	Orifice Cover Plate
	001 8104	4	1/4 - 20 x 1/2" Self Tapping Screw

Ref.	Part No.	Qty.	Description
6	124 2831	13	Air Straightener - Slotted
	001 8103	26	10 - 24 x 1/2" Self Tapping Screw
7	128 3004	1	Eddy Baffle
	001 8106	2	10 - 32 x 3/4" Machine Screw
	000 8156	2	10 - 32 Nut
8	128 8363	1	Vaporizer Adj. Decal (LP Gas)
9	128 0267	1	Fan Orifice Weld.
10	124 2832	1	Inlet Pipe Seal
	001 8297	3	8 - 18 x 3/4" Self Tapping Screw

Burner and Air Stabilizer

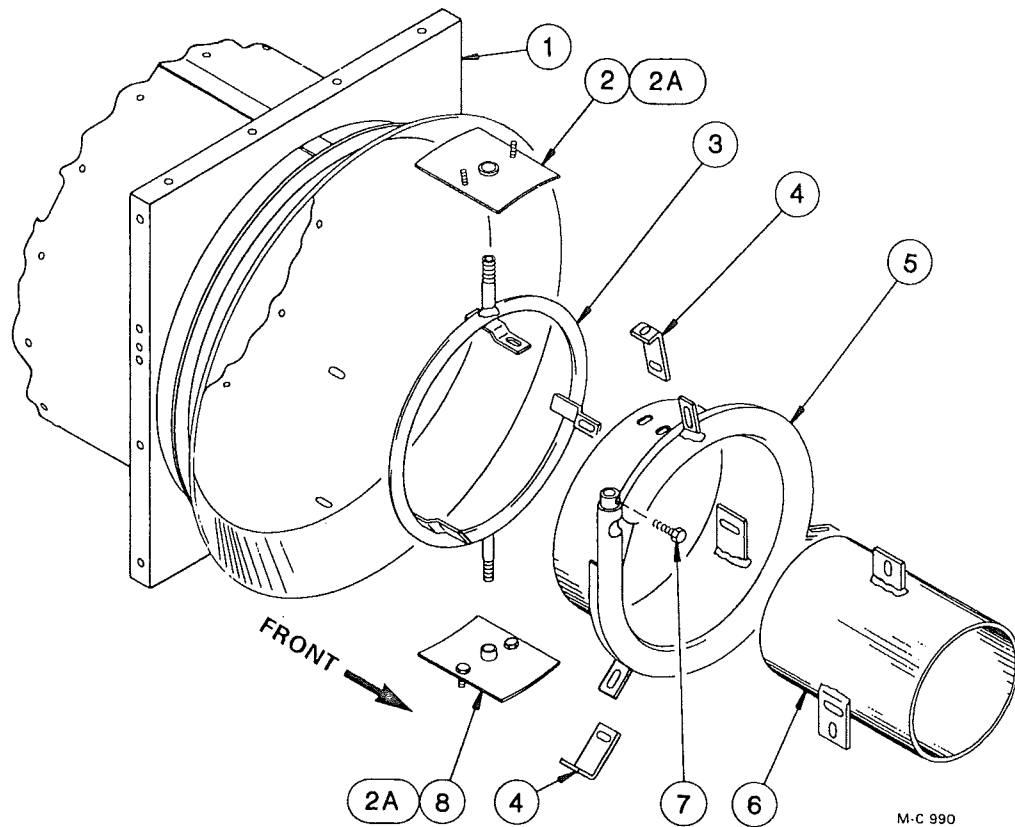

M-C 990

NOTE: Quantities shown are for one burner.

Ref.	Part No.	Qty.	Description	Ref.	Part No.	Qty.	Description
1	128 0267	1	Fan Orifice Weld.	5	121 0132	1	Ring Burner Weld.
2	128 0269	1	Vaporizer Seal - 3/4"	6	121 0131	1	Air Stabilizer
	000 8173	2	5/16" Flatwasher		000 8121	3	3/8" - 16 x 1" Capscrew
	000 8169	2	5/16 - 18 Flanged Locknut		000 8174	3	3/8" Flatwasher
2A	128 0279	1	Seal Plate (Natural Gas)		000 8168	3	3/8" - 16 Flanged Locknut
	000 8173	2	5/18" Flatwasher	7	128 8115	1	5/16 - 18 x 1" Stainless Steel Capscrew
	000 8169	2	5/16 - 18 Flanged Locknut	8	128 0270	1	Vaporizer Seal - 1/2" (LP Gas)
3	128 0274	1	Vaporizer Ring (LP Gas)		000 8173	2	5/16" Flatwasher
	000 8121	3	3/8" - 16 x 1" Capscrew		000 8169	2	5/16 - 18 Flanged Locknut
	000 8174	3	3/8" Flatwasher				
	000 8168		3/8" - 16 Flanged Locknut				
4	121 3459	3	Burner Mtg. Angle				
	000 8121	6	3/8" - 16 x 1" Capscrew				
	000 8174	6	3/8" Flatwasher				
	000 8168	6	3/8" - 16 Flanged Locknut				

Fans and Fan Motor Mount

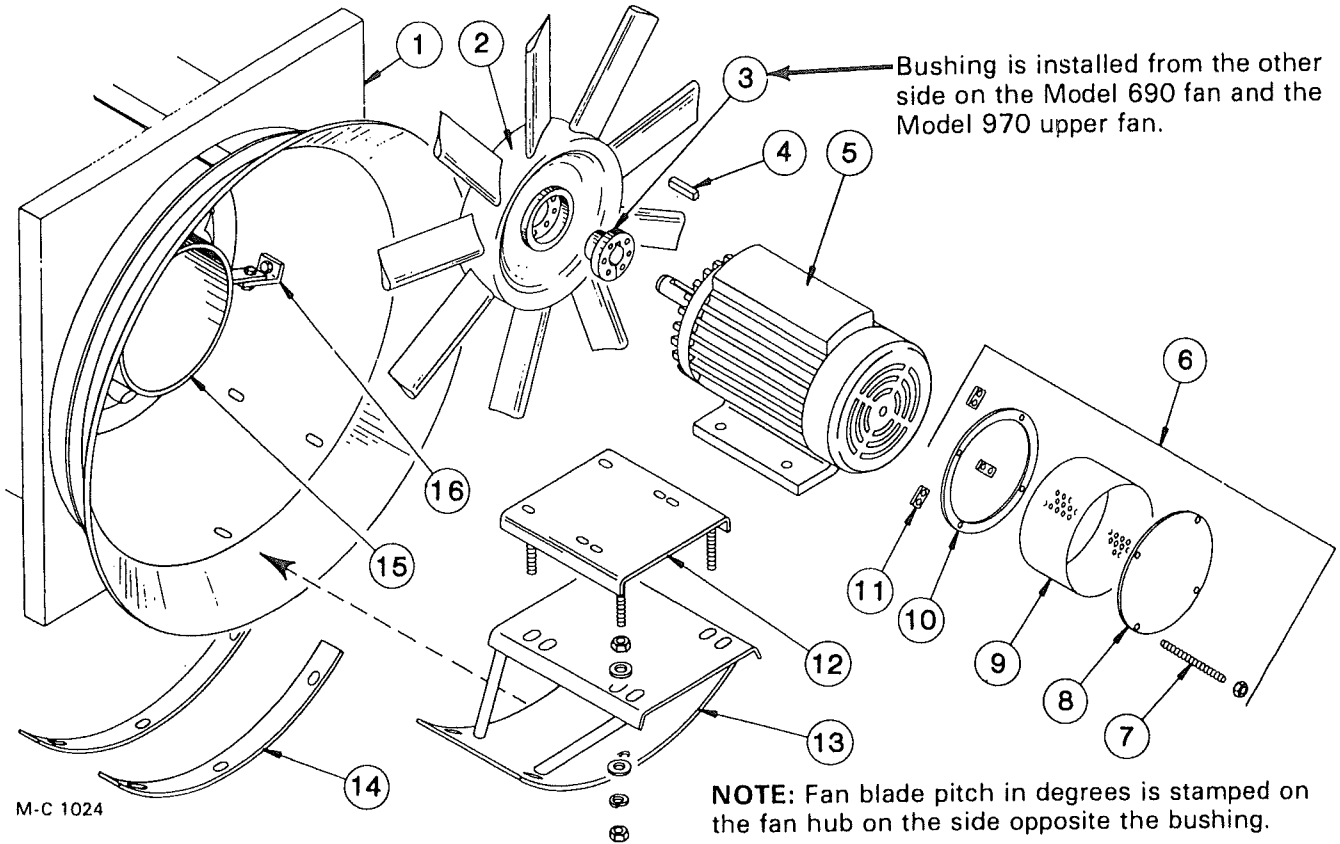

M-C 1024

NOTE: Fan blade pitch in degrees is stamped on the fan hub on the side opposite the bushing.

NOTE: Quantities shown are for one fan assembly.

Ref.	Part No.	Qty.	Description
1	128 0267	1	Fan Orifice Weld
2	---	---	Fan
	121 0331	1	670 Lower (6 blade 18°)
	121 0337	1	670 Upper and 970 Lower (9 blade 18°)
	121 0272	1	690 and 970 Upper (9 blade 27°)
3	121 6239	—	"SK" Bushing - 1 3/8" Bore (7.5 & 10 HP motors)
	121 6229	—	"SK" Bushing - 1 1/2" Bore (15 & 20 HP motors)
	121 8117	3	5/16 - 18 x 2" Socket Hd. Capscrew - Grd. 5
4	001 5124	1	Key - 5/16" x 2 3/8" (7.5 & 10 HP motor)
	001 5139	1	Key - 3/8" x 3" (15 & 20 HP motor)
5	---	---	Fan Motor (See page 45-47)
	000 8293	4	3/8 - 16 x 1 1/2" Capscrew - Full Thread (7.5 & 10 HP motor)
	000 8168	4	3/8 - 16 Flanged Locknut
	000 8139	4	1/2 - 13 x 1 3/4" Capscrew (15 & 20 HP motor)
	000 8170	4	1/2 - 13 Flanged Locknut

Ref.	Part No.	Qty.	Description
6	128 1946	1	Air Filter Ass'y. (For 1 phase 20 HP motor)
7	123 5710	4	5/16 - 18 x 6" Rod
	000 8169	8	5/16 - 18 Flanged Locknut
8	128 4902	1	Front Plate
9	128 4903	1	Body
10	128 4901	1	Rear Seal
11	124 2837	4	Mounting Retainer
12	128 0167	1	Motor Mt. (7.5 & 10 HP motor)
	121 0343	1	Motor Mt. (15 & 20 HP motor)
	000 8165	8	3/4 - 10 Hex Nut
	000 8177	8	3/4" Flatwasher
	000 8182	4	3/4" Lockwasher
13	121 0258	1	Motor Mt. Base
	000 8136	5	1/2 - 13 x 1" Carriage Bolt
	000 8170	5	1/2 - 13 Flanged Locknut
14	121 3356	2	Orifice Reinforcement
15	121 0131	1	Air Stabilizer
16	121 3459	3	Burner Mtg. Angle

Fan Orifice Supports and Fan Guard

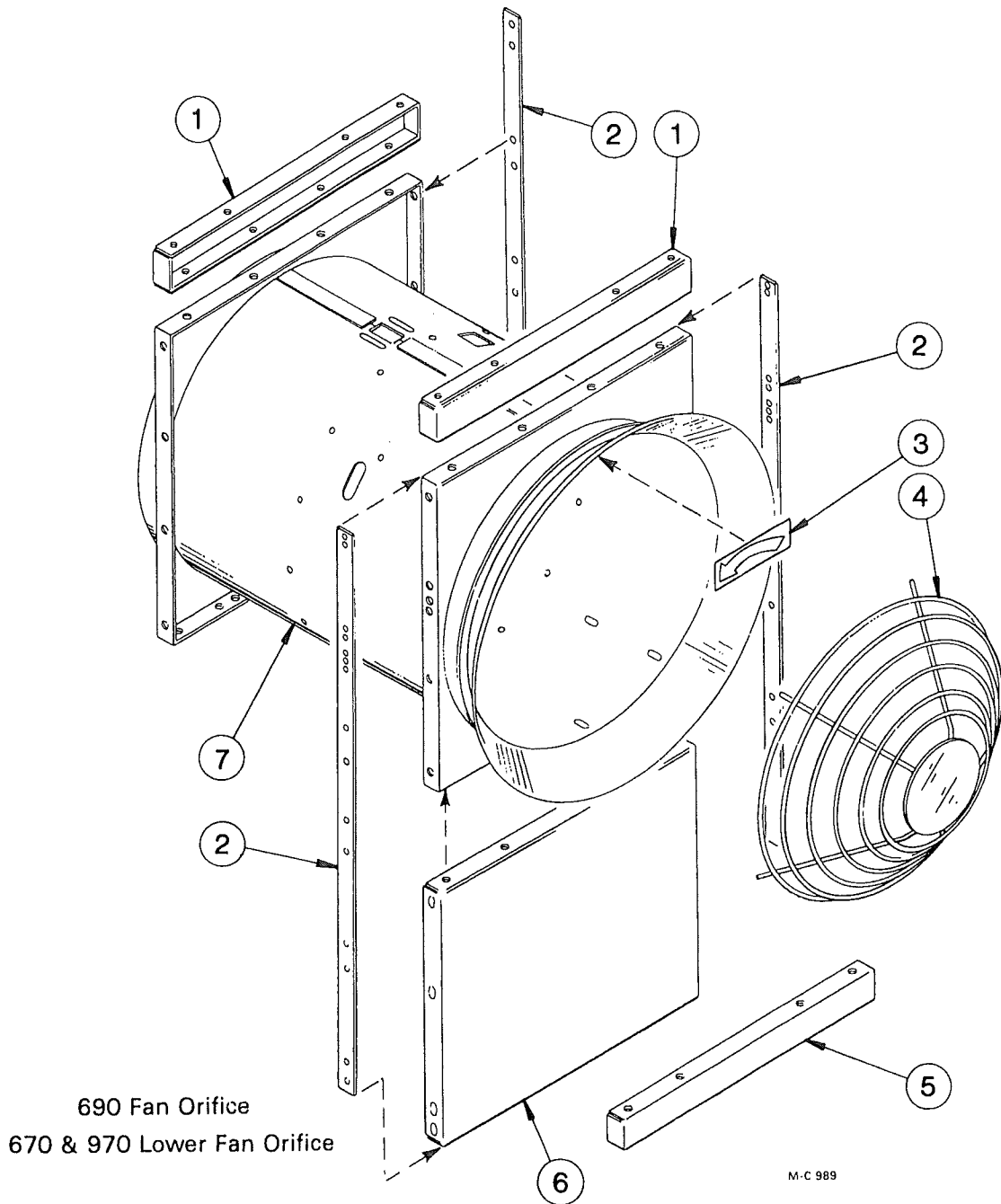

Ref.	Part No.	Qty.	Description
1	128 0273	2	Orifice Joiner Channel (670 & 970)
2	128 3463	3	Fan Housing Brace (690)
3	121 8301	1	Counterclockwise Arrow Decal
4	121 8956	—	Fan Guard
5	128 0272	1	Orifice Support Channel (670 & 970)
6	128 4445	1	Spacer Panel - Front (690)
7	128 0267	—	Fan Orifice Weld.

This page intentionally blank.

Electrode and Flame Sensing Probe

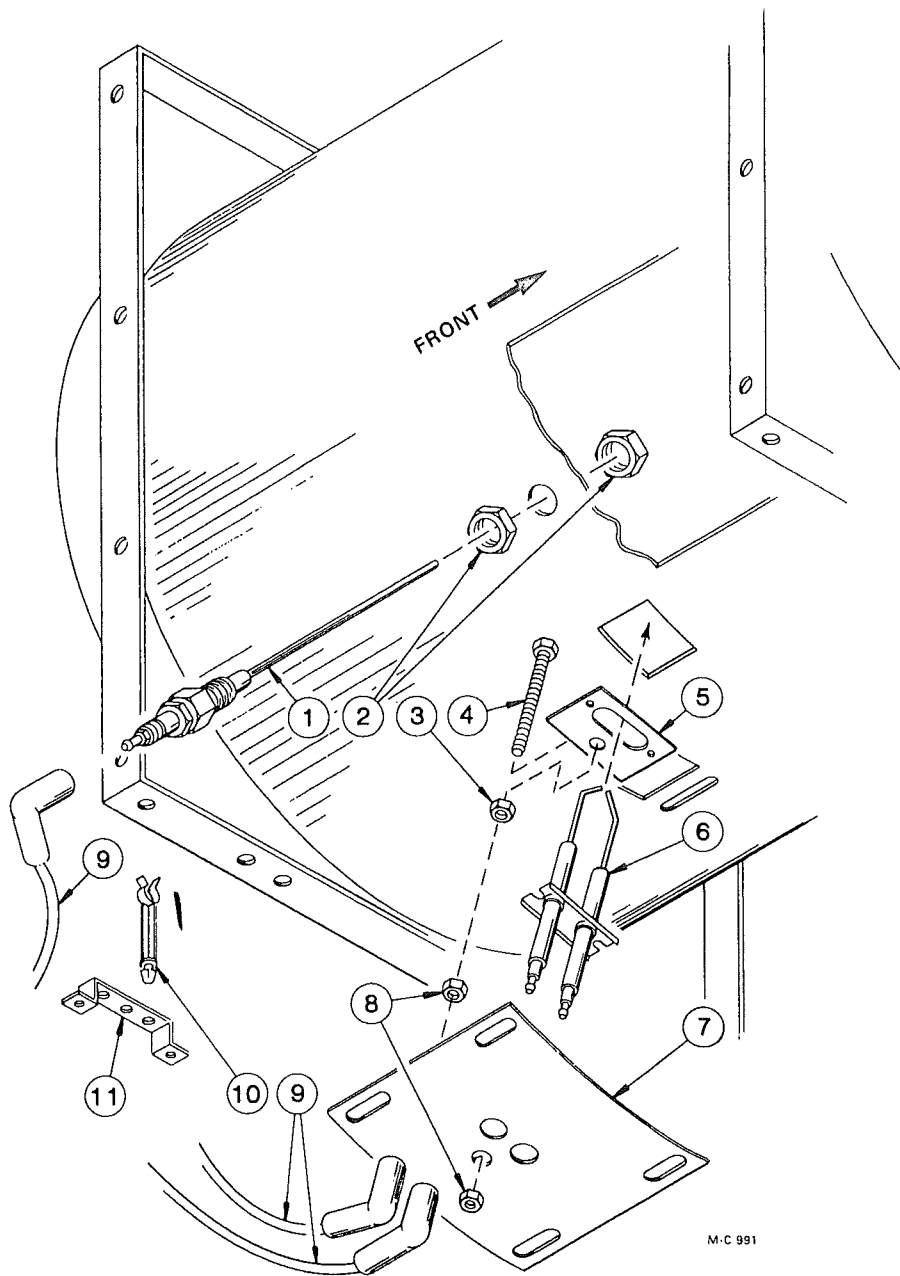

M-C 991

NOTE: Quantities shown are for one burner.

Ref.	Part No.	Qty.	Description	Ref.	Part No.	Qty.	Description
1	124 6872	1	Flame Sensing Probe	7	128 2747	1	Electrode Mt. Seal
2	121 6915	2	Locknut - 1/2"		001 8104	4	1/4 - 20 x 1/2" Self Tapping Screw
3	000 8162	1	3/8 - 16 Hex Nut	8	000 8168	2	3/8 - 16 Flanged Locknut
4	000 8227	1	3/8 - 16 x 2 3/4" Capscrew - Full Thread	9	122 9003	3	Ignition and Remote Sensing Wire
5	128 2746	1	Electrode Mt. Plate	10	128 6989	3	Stand-Off Clip
6	128 6995	1	Style 2 Electrode	11	128 4941	1	Wire Support Brkt. (On bottom burner)
	000 8186	2	6 - 32 x 1/2" Machine Screw				
	000 8245	2	No. 6 Lockwasher				
	000 8185	2	6 - 32 Flanged Locknut				

This page intentionally blank.

LP Gas Liquid Line Piping

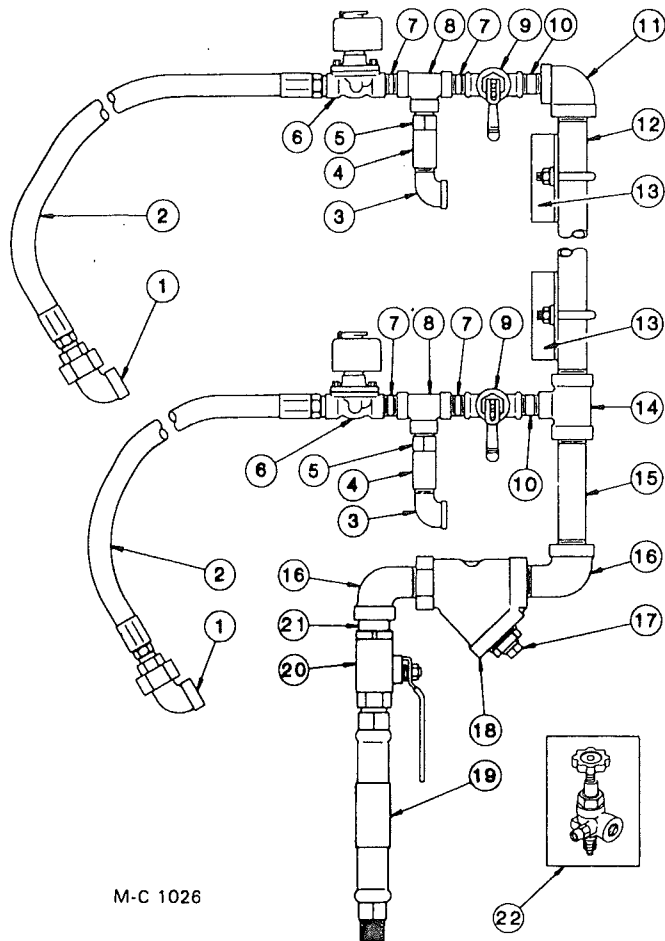

M-C 1026

670 & 970

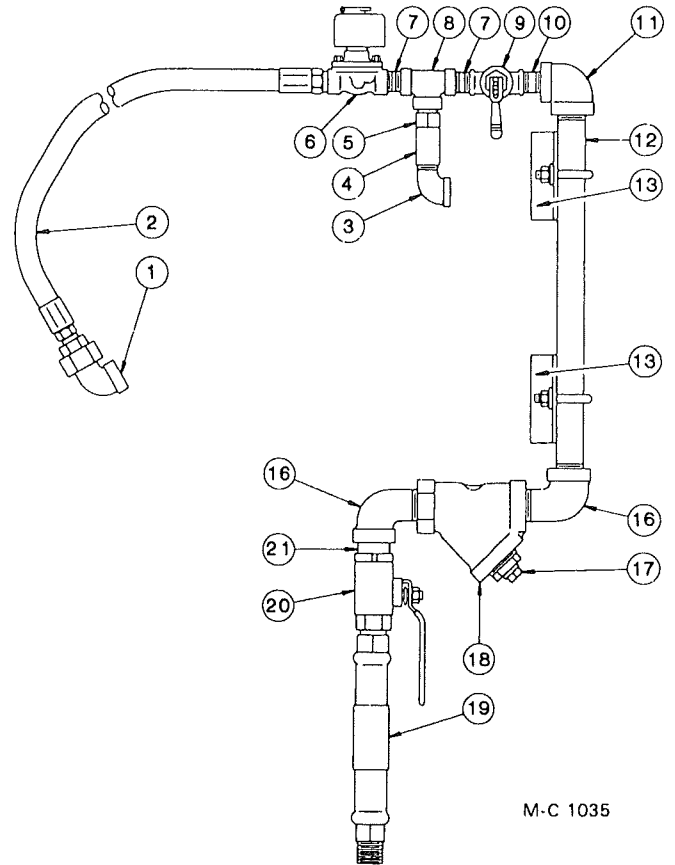

M-C 1035

690

Ref.	Part No.	Description
1	128 8010	½" Extra Hvy. Union Elbow
2	128 8400	½" ID x 34" Hose w/Couplings
3	121 8048	½" - 90° Std. Street Elbow
4	121 7013	Relief Valve
5	121 7014	Relief Valve Adapter
6	125 7082	½" Solenoid Valve
7	121 8094	½" x 1½" Extra Hvy. Nipple
8	120 8035	½" Extra Hvy. "T"
9	121 7015	Hand Valve - ½"
10	128 8048	½" x 2½" Extra Hvy. Nipple
11	121 8043	1" to ½" - 90° Extra Hvy. Elbow
12	128 8062	1" x 43" Extra Hvy. Nipple (670 & 970)
	128 8055	1" x 16½" Extra Hvy. Nipple (690)

Ref.	Part No.	Description
13	128 2670	Liquid Line Support
	001 8123	5/16 - 18 x 1⅜" "U" Bolt
	000 8106	5/16 - 18 x ¾" Capscrew
	000 8169	5/16 - 18 Flanged Locknut
14	125 8018	1" x 1" x ½" Extra Hvy. "T"
15	128 8043	1" x 6" Extra Hvy. Nipple
16	125 8028	1" - 90° Extra Hvy. Street Elbow
17	121 8081	½" Pipe Plug
18	125 8095	1" Strainer
19	121 7026	Inlet Hose
20	128 8012	Hand Valve - 1"
21	125 8030	1" Close Extra Hvy. Nipple
22	121 7021	LP Gas Tank Valve

LP Gas Manifold and Piping

(For One Burner)

Ref.	Part No.	Description
1	123 8062	1 1/4" - 90° Std. Street Elbow
2	122 7023	Power Element 90°-210°F (15' Capillary) Code "B"
	122 7036	Power Element 140°-250°F (15' Capillary) Code "D"
3	123 8069	1 1/4" Std. Close Nipple
4	123 7003	Hand Valve - 1 1/4"
5	127 8131	1 1/4" x 1 1/4" x 3/8" Std. "T"
6	128 7001	1 1/4" Solenoid Valve
7	121 8050	3/4" Pipe Cap
8	121 8077	3/4" x 2" Std. Nipple
9	121 8052	3/4" x 3/4" x 1 1/4" Std. "T"
10	125 8013	1 1/4" x 2" Std. Nipple
11	124 4219	Piping Brkt.
	000 8119	3/8" - 16 x 3/4" Capscrew
	000 8174	3/8" Flatwasher
	000 8168	3/8" - 16 Flanged Locknut
	001 8123	5/16" - 18 x 1 3/8" "U" Bolt
	000 8173	5/16" Flatwasher
	000 8169	5/16" - 18 Flanged Locknut
12	121 8089	3/4" x 5" Std. Nipple
13	121 8028	3/4" Std. Union
14	128 8031	3/4" x 3 1/2" Std. Nipple
15	121 8039	1/4" - 90° Std. Street Elbow (For regulator 121 7006)
	121 8033	3/4"-90° Std. Street Elbow (For regulator 128 7005)
16	128 7005	LP Gas Pressure Regulator (Replaces 121 7006)
17	121 8005	3/4" x 1 1/2" Extra Hvy. Nipple
18	001 8001	3/8" Std. Pipe Plug
19	121 8060	3/4" Strainer
20	121 8008	3/4" x 3" Extra Hvy. Nipple
21	128 8019	3/4" Extra Hvy. Female Union Elbow
22	121 8097	3/4" x 20 1/2" Extra Hvy. Nipple
23	121 8027	3/4" - 90° Extra Hvy. Elbow
24	123 8049	1 1/4" to 3/4" Std. Reducing Elbow
25	121 7529	Burner Inlet Pipe
26	021 5711	Burner Nozzle - 5/16" Orifice
27	123 8085	1 1/4" x 19" Std. Nipple
28	123 8051	1 1/4" - 90° Std. Elbow
29	128 8024	1 1/4" x 5 Std. Nipple
30	123 8053	1 1/4" Std. Union
31	127 8021	1 1/4" x 9 1/2" Std. Nipple

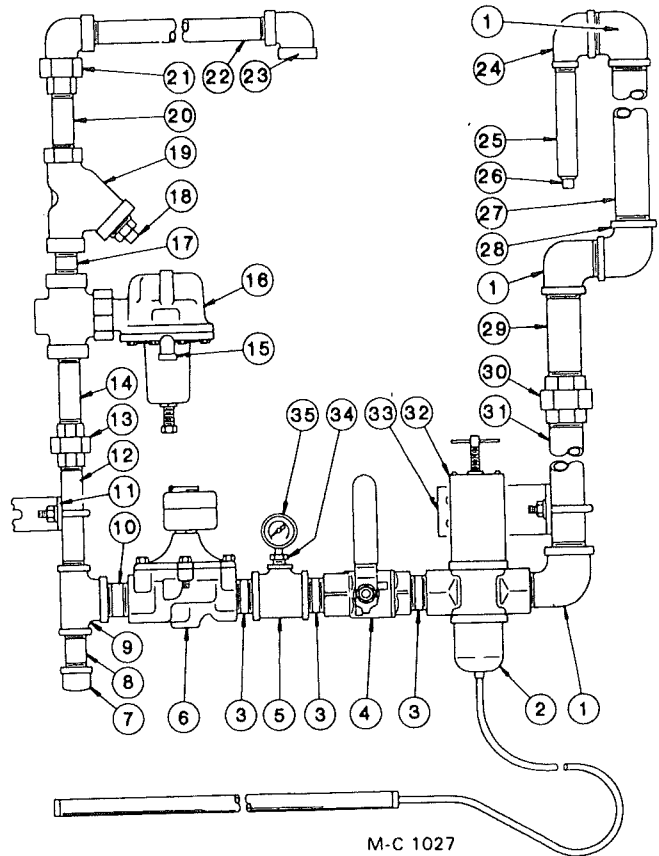

Ref.	Part No.	Description
32	123 7002	1 1/4" Modulating Valve w/ 90°-210°F Power Element (670 & 970 bottom burner)
	123 7024	1 1/4" Modulating Valve w/ 140°-250° Power Element (690 and 670 & 970 top burner)
33	124 4220	Piping Brkt.
	000 8119	3/8" - 16 x 3/4" Capscrew
	000 8174	3/8" Flatwasher
	000 8168	3/8" - 16 Flanged Locknut
	123 8110	5/16" - 18 x 1 3/4" "U" Bolt
	000 8173	5/16" Flatwasher
	000 8169	5/16" - 18 Flanged Locknut
34	127 8132	3/8" to 1/4" Reducing Bushing
35	120 7002	Gas Pressure Gauge

Repair Kits

Repair kits for modulating valves, solenoid valves and LP gas pressure regulators are shown on page 26.

Natural Gas Manifold and Piping

(For One Burner)

Ref.	Part No.	Description
1	128 8024	1 1/4" x 5" Std. Nipple
2	128 7001	1 1/4" Solenoid Valve
3	125 8013	1 1/4" x 2" Std. Nipple
4	123 8051	1 1/4" - 90° Std. Elbow
5	123 8045	1 1/4" x 2 1/2" Std. Nipple
6	123 8053	1 1/4" Std. Union
7	123 8069	1 1/4" Std. Close Nipple
8	127 8131	1 1/4" x 1 1/4" x 3/8" Std. "T"
9	123 7003	Hand Valve - 1 1/4"
10	122 7023	Power Element 90°-210°F (15' Capillary) Code "B"
	122 7036	Power Element 140°-250°F (15" Capillary) Code "D"
11	123 8062	1 1/4" - 90° Std. Street Elbow
12	124 4219	Piping Brkt.
	000 8119	3/8" - 16 x 3/4" Capscrew
	000 8174	3/8" Flatwasher
	000 8168	3/8" - 16 Flanged Locknut
	123 8110	5/16" - 18 x 1 3/4" "U" Bolt
	000 8173	5/16" Flatwasher
	000 8169	5/16" - 18 Flanged Locknut
13	120 7002	Gas Pressure Gauge
14	127 8132	3/8" to 1/4" Reducing Bushing
15	124 4220	Piping Brkt.
	000 8119	3/8" - 16 x 3/4" Capscrew
	000 8174	3/8" Flatwasher
	000 8168	3/8" - 16 Flanged Locknut
	123 8110	5/16" - 18 x 1 3/4" "U" Bolt
	000 8173	5/16" Flatwasher
	000 8169	5/16" - 18 Flanged Locknut
16	123 7002	1 1/4" Modulating Valve w/ 90°-210°F Power Element (670 & 970 bottom burner)
	123 7024	1 1/4" Modulating Valve w/ 140°-250°F Power Element (690 and 670 & 970 top burner)
17	127 8021	1 1/4" x 9 1/2" Std. Nipple
18	123 8085	1 1/4" x 19" Std. Nipple
19	123 5531	Burner Nozzle - 3/8" Orifice
20	121 7529	Burner Inlet Pipe
21	123 8049	1 1/4" to 3/4" Reducing Elbow

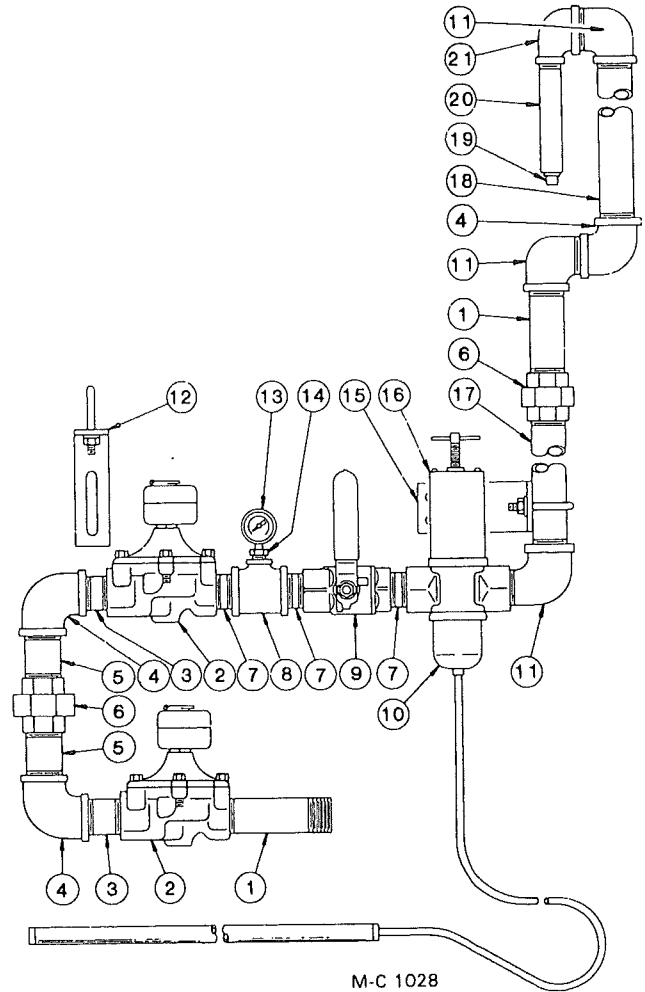

Repair Kits

Repair kits for modulating valves, solenoid valves and LP gas pressure regulators are shown on page 26.

Repair Kits and Parts for Modulating Valves, Solenoid Valves and LP Gas Pressure Regulators

For Modulating Valves 123 7002 & 123 7024

122 9993 Seat Kit (Incl. stem, disc holder & diaphragm)
122 7006 Diaphragm

For 1 1/4" Solenoid Valve 128 7001

122 7034 Repair Kit (See note)
--- 4607 Coil

For 1/2" Solenoid Valve 125 7082

122 7039 Repair Kit (See note)
122 7001 Coil

NOTE: Kit includes all internal parts that would require replacement in normal service and installation instructions.

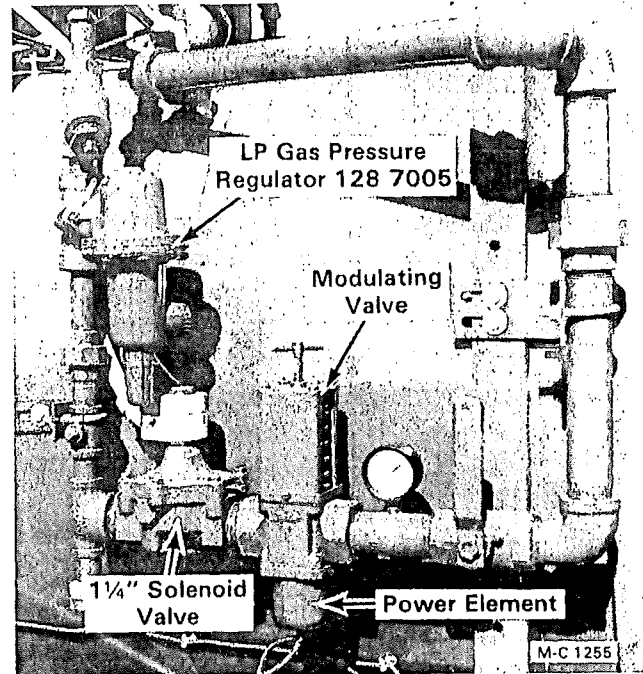

For LP Gas Pressure Regulator 121 7006

122 7004 Diaphragm
122 7016 Disc & Disc Holder
122 7017 Red Spring
122 8607 Snap Ring (2 reqd.)
122 8608 Body Gasket

For LP Gas Pressure Regulator 128 7005

122 7043 Diaphragm (Nitrile)
122 7044 Disc Assembly
122 7045 Control Spring (Yellow)
122 7046 Stabilizer
122 7047 Diaphragm Case O Ring

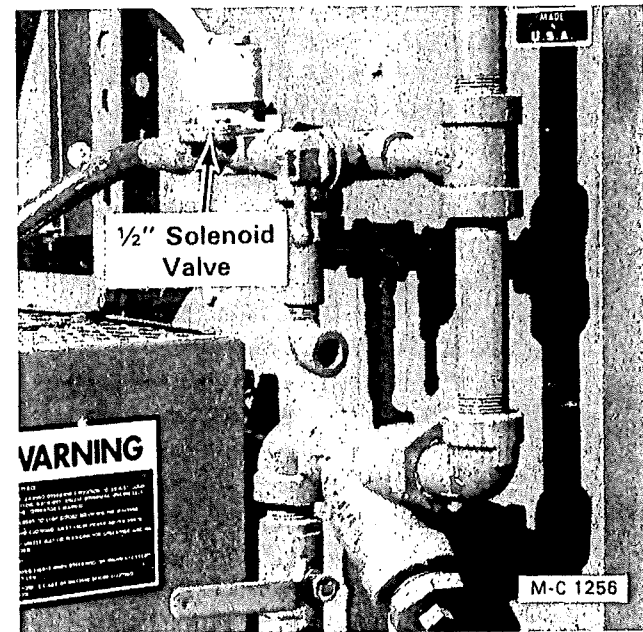

Fisher LP Gas Pressure Regulators

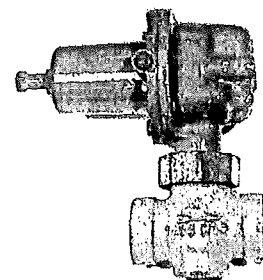

M-C 1216

121 7006

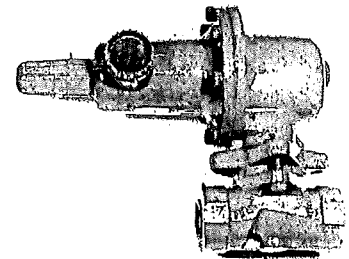

128 7005

115V Control Cabinet

(Model 970 Below S/N 47164)

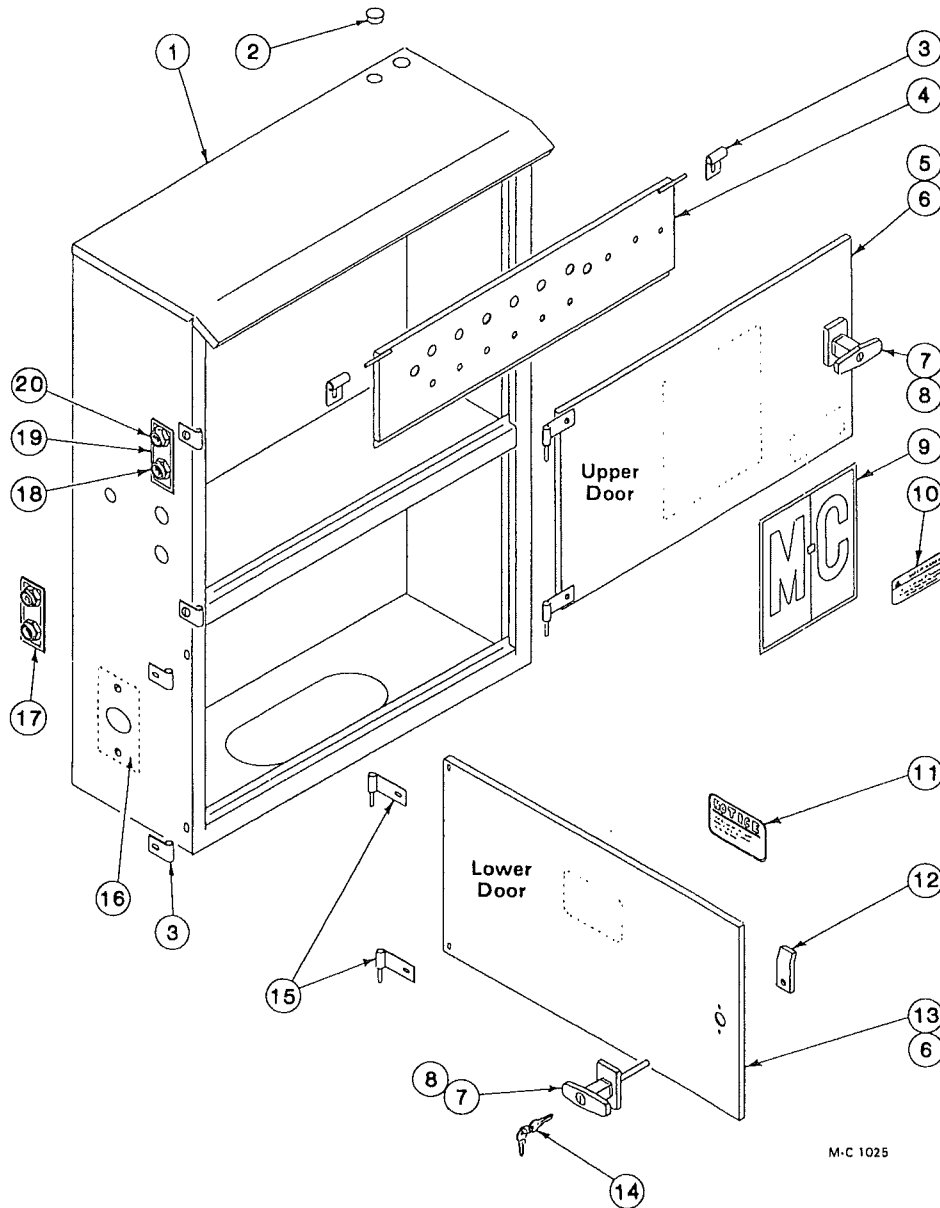

Ref.	Part No.	Qty.	Description	Ref.	Part No.	Qty.	Description
1	128 0240	1	115 V Control Cabinet Weld	9	001 8302	1	M-C Decal - 8-3/16" x 9"
2	121 8600	2	1/2" Hole Plug	10	121 8316	1	Dryer Warning Decal
3	121 4656	6	Door Hinge w/o Pin	11	001 8310	1	Machine Warranty Decal
4	021 0013	1	Hinged Light Door (Field modification required)	12	128 3425	2	Door Handle Cam
5	021 1044	1	Upper Door Ass'y (Incl. ref. 6, 7, 9, 10 & 15)	13	021 1037	1	Lower Door Ass'y. (Incl. ref. 6, 7, 11 & 15)
6	021 4769	1	Door - Upper and Lower	14	122 8900	2	Door "T" Handle Key
7	124 1021	2	Door "T" Handle Ass'y. (Incl. ref. 12 cam, ref. 14 keys and mtg. hdwe.)	15	021 0012	4	Door Hinge w/Pin
			Lever type handle no longer available.	16	128 4848	1	Hole Cover
8	128 8946	2	Door "T" Handle w/Keys (Less ref. 12 cam)	17	128 8316	1	Start & Stop Plate - Fan 2
				18	128 6844	2	Start Button - Black
				19	128 8315	1	Start & Stop Plate - Fan 1
				20	128 6845	2	Stop Button - Red

Motor Control Cabinet

(Model 970 Below S/N 47164)

M-C 951

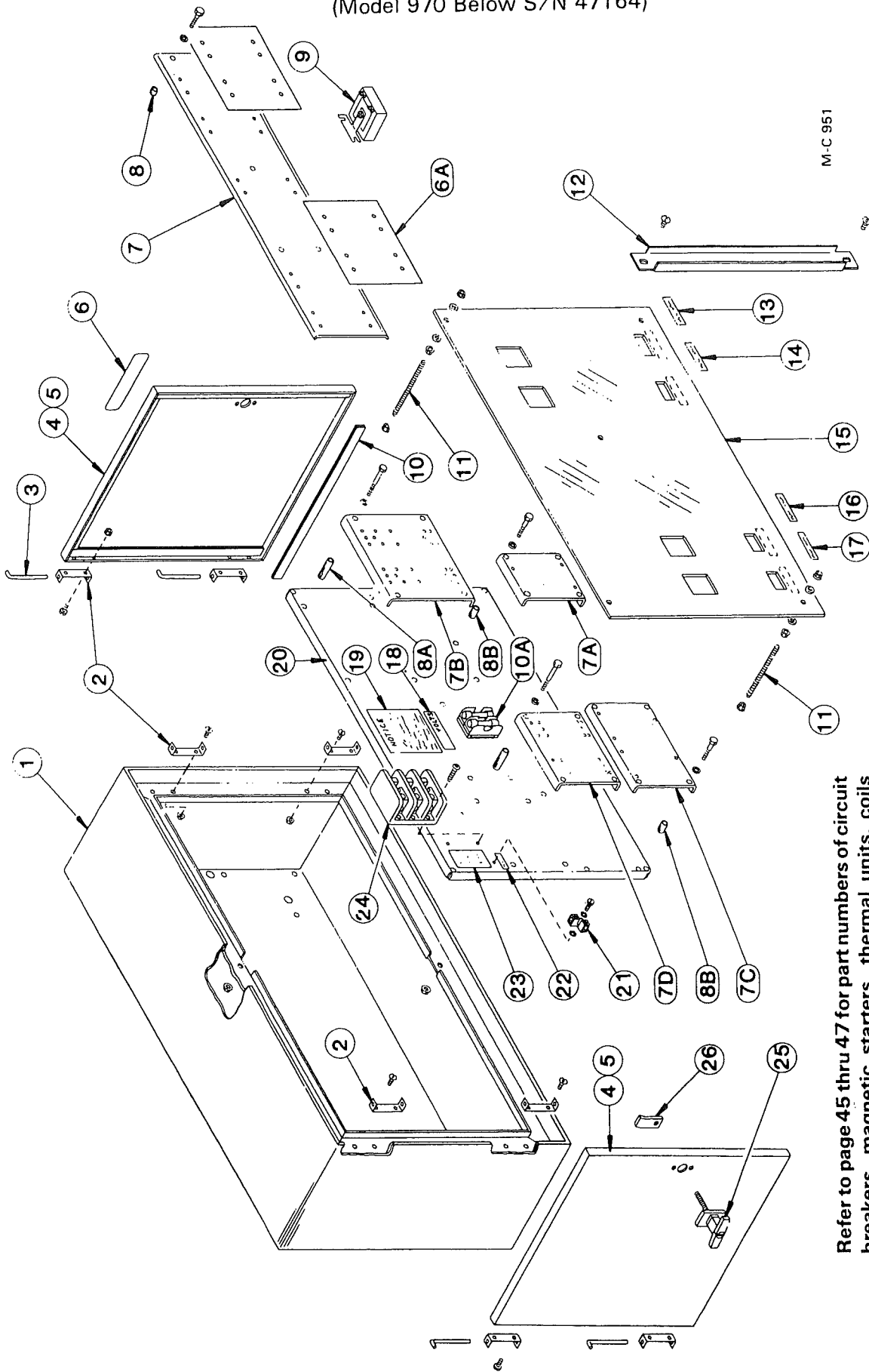

Refer to page 45 thru 47 for part numbers of circuit breakers, magnetic starters, thermal units, coils and interlocks.

Motor Control Cabinet

(Model 970 Below S/N 47164)

NOTE: All types of magnetic starters and circuit breaker mounts (ref. 7 thru 7D), and spacers (ref. 8, 8A & 8B) are illustrated. Type used depends on dryer operating voltage. Use the illustration to select the correct mounts and spacers for your dryer.

Ref.	Part No.	Qty.	Description	Ref.	Part No.	Qty.	Description
1	128 0194	1	Motor Control Cabinet Weld	15	-----	—	Guard Panel (Lexan) - See Note
2	128 2740	8	Door Hinge		128 5964	1	460V & 575V
3	128 5201	4	Hinge Pin		128 5966	1	200/208V & 230V (3 Phase)
4	128 1329	2	Door Ass'y. - Left & Right (Incl. ref. 2, 5, 10 & 25)	16	128 8335	1	Unload Auger Decal
5	128 4844	2	Door - Left & Right	17	121 8351	1	Level Auger Decal
6	121 8316	1	Dryer Warning Decal	18	123 8339	1	208 Volts Decal
6A	128 5789	2	Insulator Sheet (460V & 575V)		123 8336	1	230 Volts Decal
7	128 4565	—	Circuit Breaker Mt. (460V - 575V)		123 8335	1	460 Volts Decal
7A	124 4449	—	Magnetic Starter Mt. (Single)		123 8338	1	575 Volts Decal
7B	124 4452	—	Circuit Breaker Mt. (Fan Motor)	19	121 8315	1	Notice, Warranty Decal
7C	124 4450	—	Magnetic Starter Mt. (Dual)	20	124 4448	1	Component Mounting Panel
7D	124 4451	—	Circuit Breaker Mt. (Level & unload auger motor)	21	125 6918	1	Grounding Lug
8	127 5400	—	Spacer - 1/4" x 3/8"	22	128 8349	1	Ground Decal
8A	128 5402	—	Spacer - 1/4" x 2 1/8"	23	128 8318	2	Splitter Block Voltage Decal
8B	128 5403	—	Spacer - 1/4" x 15/16"	24	128 6957	1	Splitter Block - 1 & 3 Phase
9	-----	—	Not Used	25	124 1021	2	Door "T" Handle Ass'y. (Incl. ref. 26 cam, keys and mtg. hdwe.) Lever type handle no longer available
10	121 8966	—	Weather Stripping 1/4" x 3/4" (Specify ft. reqd.)		128 8946	2	Door "T" Handle w/keys (Less. ref. 26 cam)
10A	121 6988	2	Fuse Holder (208V, 460V & 575V)		122 8900	2	Door "T" Handle Key
	124 6835	2	208V Fuse - FRN9		128 3425	2	Door Latch Cam
	124 6829	2	460V Fuse - FRS4				
	127 6839	2	575V Fuse - FRS3.2				
11	123 5710	5	Threaded Rod - 5/16 - 18 x 6"	Not Shown			
	000 8169	15	5/16 - 18 Flanged Locknut		127 6855	1	200/208V Transformer (750VA)
	000 8173	10	5/16" Flatwasher		127 6827	1	230/460V Transformer (750VA)
12	128 4843	1	Door Jamb		127 6829	1	230/460/575V Transformer (750VA)
13	121 8325	1	Upper Heat Fan Decal				
14	121 8313	1	Heat Fan Decal				

NOTE: Due to the various types of magnetic starters and circuit breakers used, it may be necessary to modify the guard panel in the field to fit properly.

115V and Motor Control Cabinet

(Model 670, 690 & 970 Above S/N 47163)

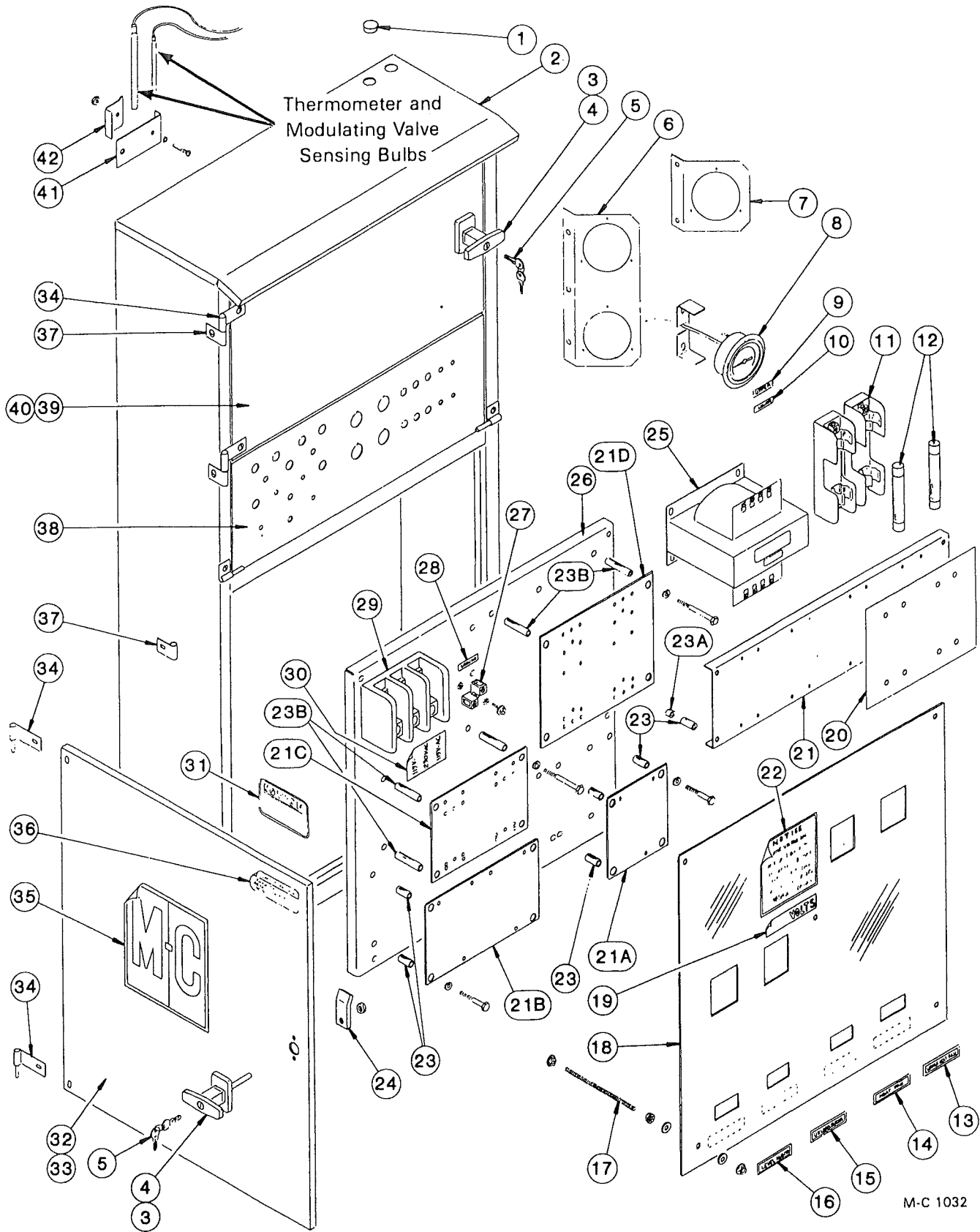

Refer to page 45 thru 47 for part numbers of circuit breakers, magnetic starters, thermal units, coils and interlocks.

115V and Motor Control Cabinet

(Model 670, 690 & 970 Above S/N 47163)

NOTE: All types of magnetic starter and circuit breaker mounts (ref. 21 thru 21D), and spacers (ref. 23, 23A & 23B) used on various dryer models are illustrated. Type used depends on dryer operating voltage and whether it is single or three phase. Use the illustration to select the correct mounts and spacers for your dryer.

Ref.	Part No.	Qty.	Description	Ref.	Part No.	Qty.	Description
1	121 8600	1	Hole Plug	19	123 8339	1	208 Volts Decal
2	128 0277	1	Control Cabinet Weld		123 8336	1	230 Volts Decal
	128 8600	—	Weather Stripping - ¼" x ½" (Specify ft. reqd.)		123 8335	1	460 Volts Decal
3	124 1021	2	Door "T" Handle Ass'y. (Inc. ref. 5 keys, ref. 24 cam and mtg. hdwe.)Lever type handle no longer available.		123 8338	1	575 Volts Decal
				20	128 5789	2	Insulator Sheet (460V & 575V)
4	128 8946	2	Door "T" Handle w/keys (Less ref. 24 cam)	21	124 4454	1	Circuit Breaker Mt. (460V & 575V)
5	122 8900	2	Door "T" Handle Key	21A	124 4449	—	Magnetic Starter Mt. (Single)
6	124 4815	1	Thermometer Mt. Plate (670 & 970)	21B	124 4450	—	Magnetic Starter Mt. (Dual)
7	124 4824	1	Thermometer Mt. Plate (690)	21C	124 4451	—	Circuit Breaker Mt. (Level & unload auger motor)
8	128 8983	—	Thermometer - 15' Capillary (Mtg. brkt. incl.)	21D	124 4452	—	Circuit Breaker Mt. (Fan motor)
9	121 8322	1	Thermometer "Upper" Decal	22	121 8315	1	Notice, Warranty Decal
10	121 8321	1	Thermometer "Lower" Decal	23	128 5403	—	Spacer - ¼" x 15/16"
11	121 6988	2	Fuse Holder (208V, 460V & 575V)	23A	127 5400	—	Spacer - ¼" x ¾"
12	124 6835	2	208V Fuse - FRN9	23B	128 5402	—	Spacer - ¼" x 2/8"
	124 6829	2	460V Fuse - FRS4	24	128 3425	2	Door Handle Cam
	127 6839	2	575V Fuse - FRS3.2	25	127 6855	1	200/208V Transformer (750VA)
13	121 8325	1	Upper Heat Fan Decal		127 6827	1	230/460V Transformer (750VA)
14	121 8313	1	Heat Fan Decal		127 6829	1	230/460/575V Transformer (750VA)
15	128 8335	1	Unload Auger Decal	26	124 4453	1	Component Mtg. Panel
16	121 8351	1	Level Auger Decal	27	125 6918	2	Grounding Lug
17	123 5710	5	Threaded Rod - 5/16 - 18 x 6"	28	128 8349	1	Ground Decal
	000 8169	15	5/16 - 18 Flanged Locknut	29	128 6957	1	Splitter Block - 1 & 3 phase
	000 8173	10	5/16" Flatwasher	30	128 8318	1	Splitter Block Voltage Decal
18	-----	—	Guard Panel (Lexan) See note	31	001 8310	1	Machine Warranty Decal
	128 5958	1	690 & 970 - 230V (1 & 3 phase)	32	128 1930	1	Lower Door Ass'y. (Incl. ref. 3, 24, & 33 thru 36)
	128 5957	1	670 - 230V (1 & 3 phase)	33	124 4816	1	Door - Lower
	128 5956	1	670, 690 & 970 - 460 & 575V	34	021 0012	4	Door Hinge w/Pin
				35	001 8302	1	M-C Decal - 8-3/16" x 9"
				36	121 8316	1	Dryer Warning Decal
				37	121 4656	6	Door Hinge w/o Pin
				38	128 0278	1	Hinged Light Door
				39	128 1908	1	Upper Door Ass'y. (Incl. ref. 3, 24, 34 & 40)
				40	021 4769	1	Door - Upper
				41	121 2883	—	Sensing Bulb Brkt.
				42	121 2882	—	Sensing Bulb Clip

NOTE: Due to the various types of magnetic starters and circuits breakers used, it may be necessary to modify the guard panel in the field to fit properly.

Electrical Components in 115V Control Cabinet

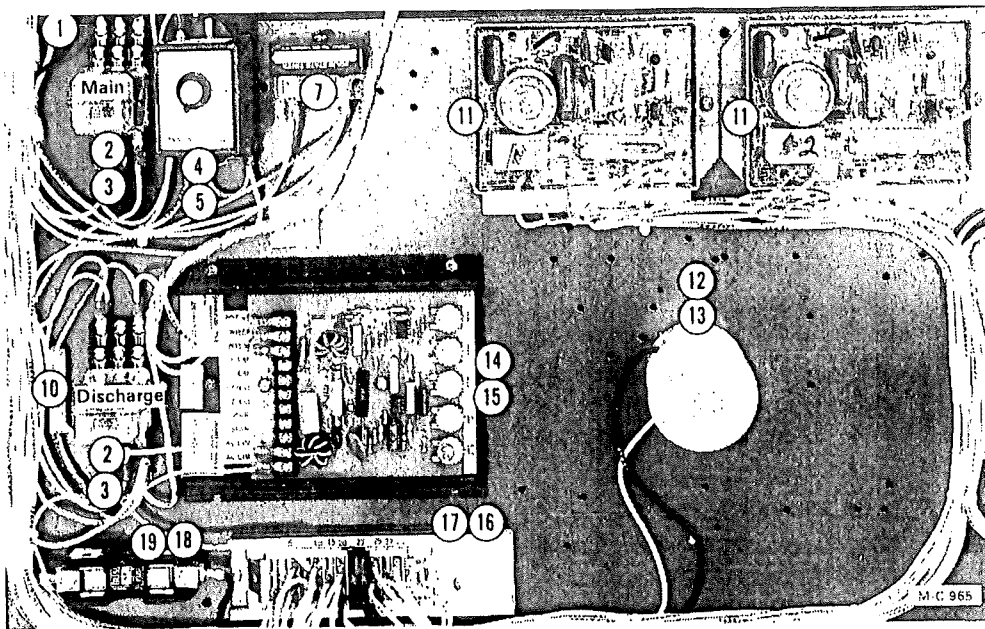

Below S/N 47164

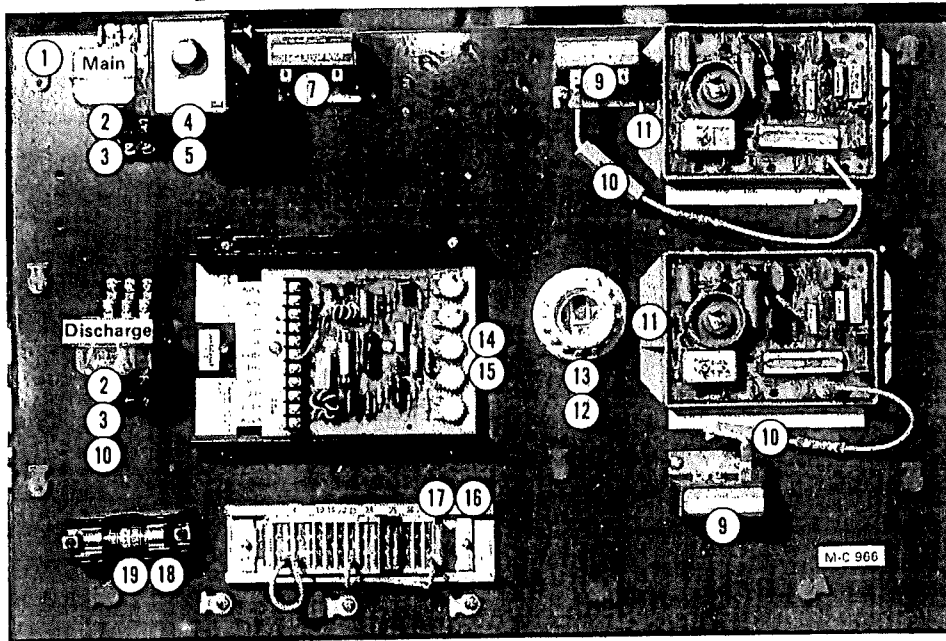

S/N 47164 thru 48980

Ref.	Part No.	Description	Ref.	Part No.	Description
1	021 4770	Component Mounting Board	11	121 6925	115V Ignition Board (Incl. ign. reset - 0.1 amp.)
2	021 6810	Relay Socket	12	124 6841	Light Bulb Socket
3	021 6809	Relay	13	124 6842	50W RS Light Bulb
4	021 6816	Timer Socket	14	124 6874	SCR Board (Dart)
5	021 6815	60 Minute Adjustable Timer	15	121 6805	10 Amp. - GLH Fuse
6	124 6890	.2 to 8 Minute Adjustable Timer	16	127 1020	Terminal Track Ass'y. (Incl. cages & end locks)
7	127 6802	1 Minute Timer		121 5200	Track - 1 7/8" x 6 1/2"
8	124 6896	30 Minute Delay		121 6818	End Lock Ass'y.
9	124 6831	10 Second Timer			
10	127 6812	Resistor (10W - 3K Ohm)			

Continued on next page

Electrical Components in 115V Control Cabinet

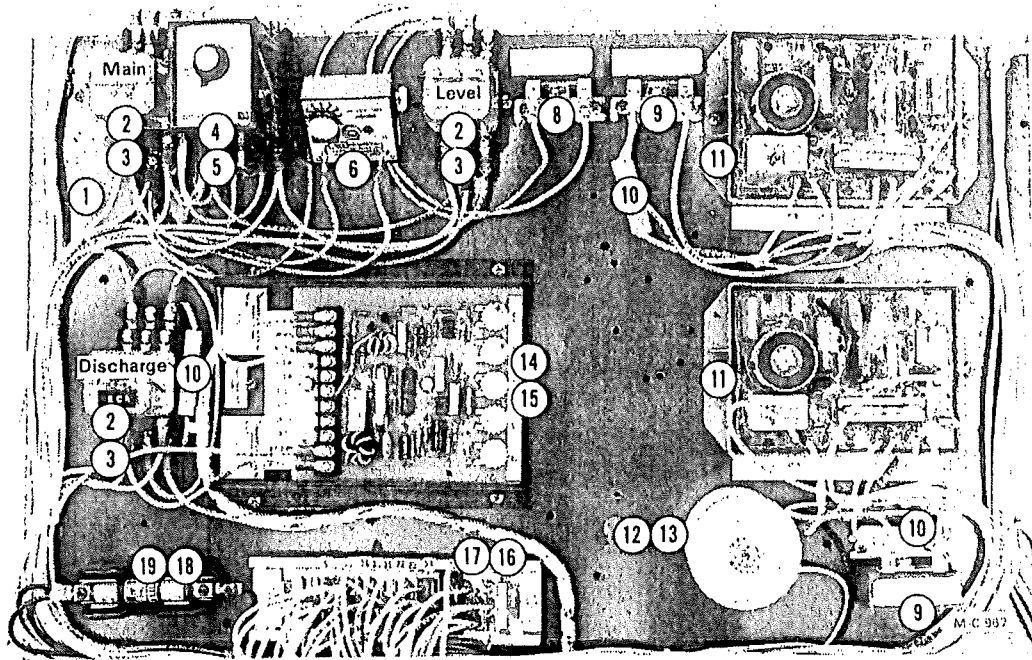

S/N 48981 thru 51558

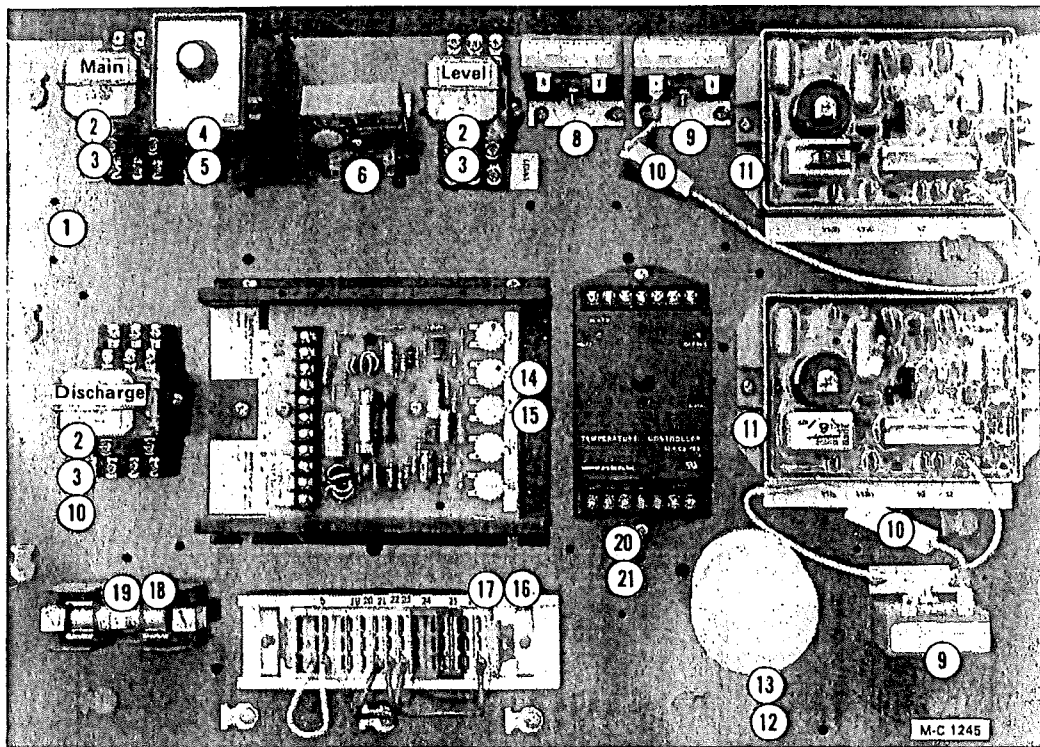

S/N 51559 and Up

Ref.	Part No.	Description	Ref.	Part No.	Description
17	---	Cage Assemblies	18	128 6851	Fuse Holder
	121 6824	3 Way - Yellow	19	128 6967	10 Amp. Fuse (NON-10)
	121 6830	6 Way - Black	20	124 6889	Moisture Control (Zytron)
	121 6831	6 Way - Yellow	21	125 6908	18/2 PVC Cord w/Shield - Not Shown (Zytron to Thermistor)
	121 6839	6 Way - White			

Control Panel Lights, Switches and Controls

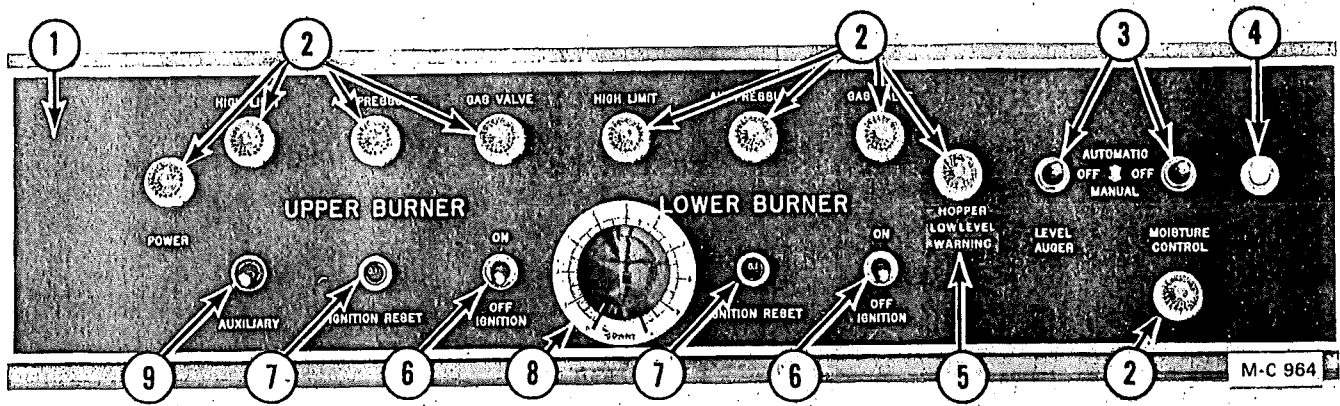

**Below S/N 47164
(Fan buttons are shown w/control cabinet)**

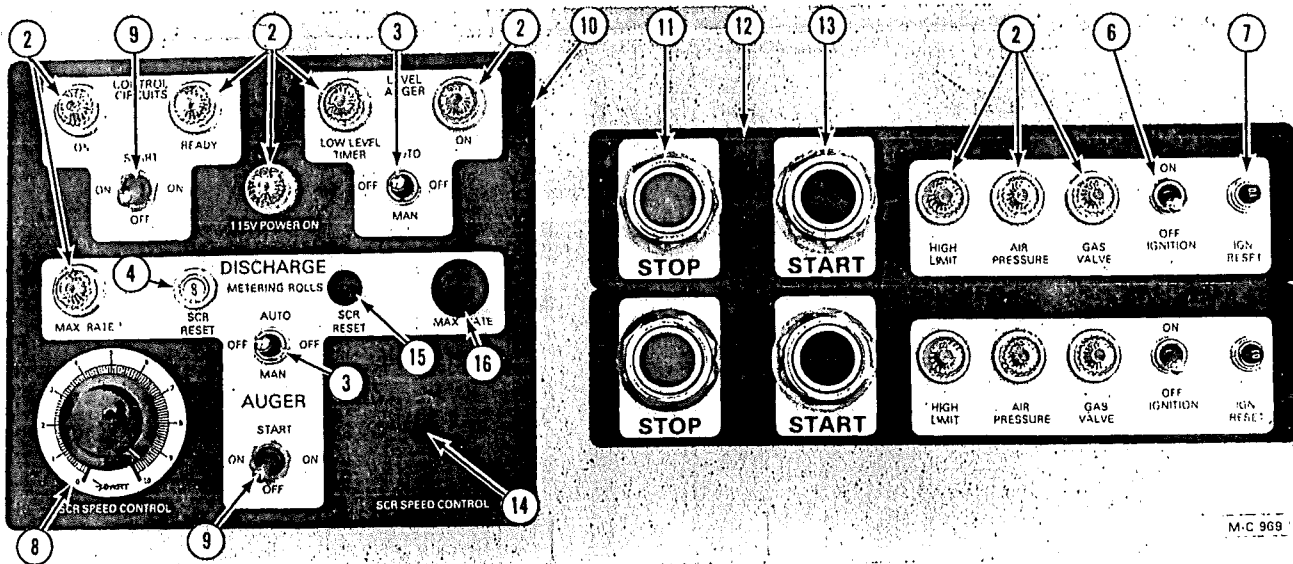

S/N 47164 thru 48980

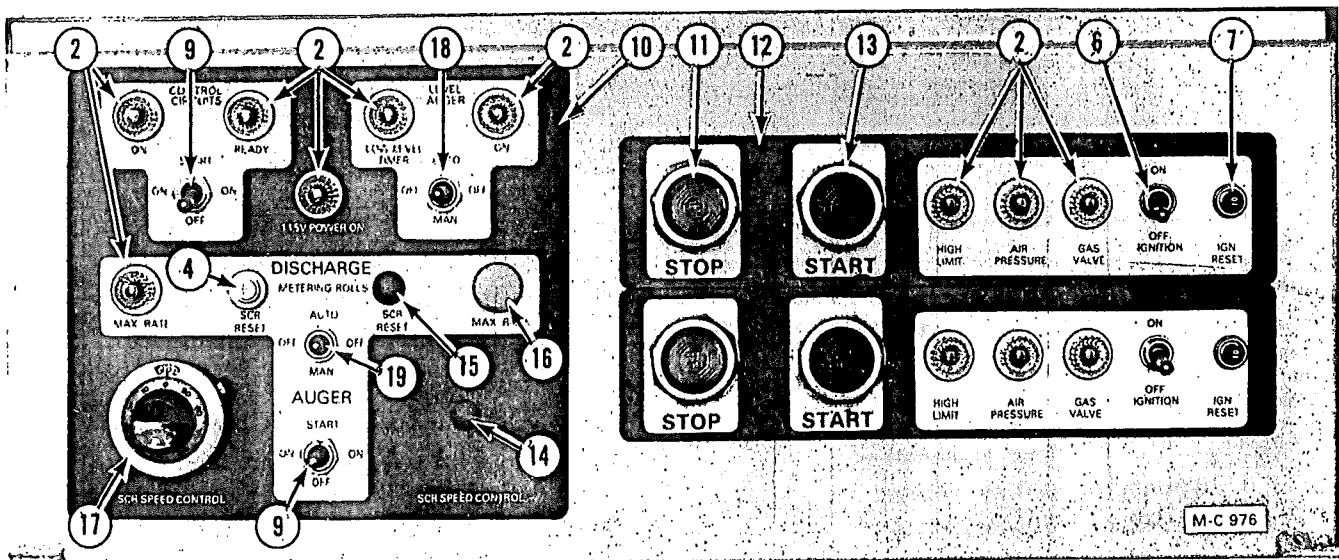

S/N 48981 thru 51558

Control Panel Lights, Switches and Controls

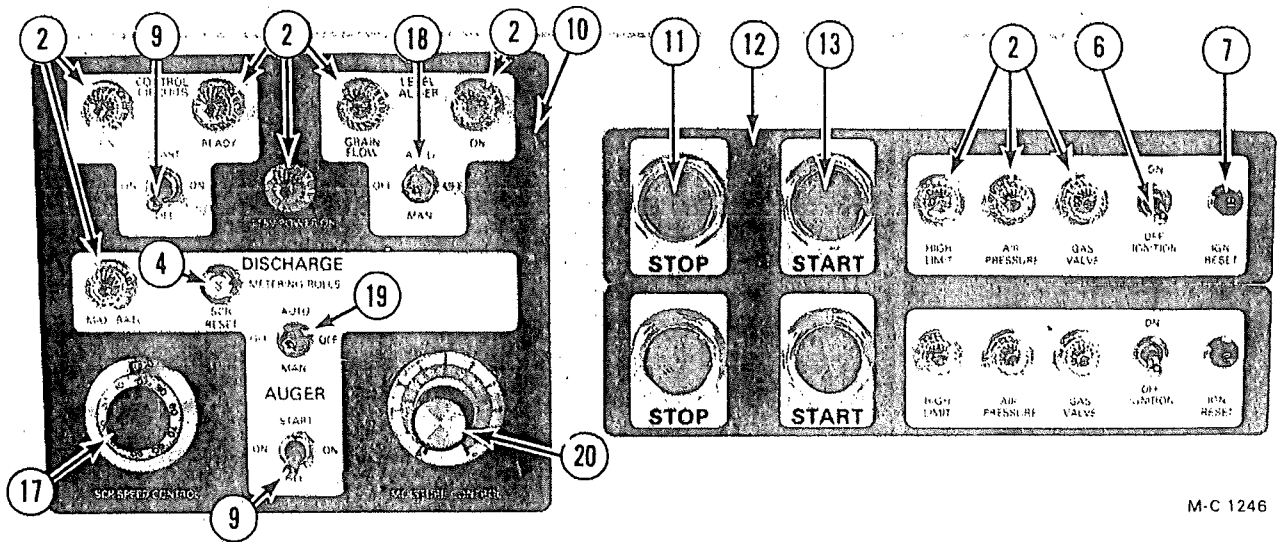

M-C 1246

S/N 51559 and Up

Ref.	Part No.	Description	Ref.	Part No.	Description
1	128 8345	Light Bezel (Field modification reqd.)	9	120 6827	Momentary Contact Toggle Switch
2	121 6808	125V Indicator Lamp (Incl. lamp & lens)	10	128 8365	115V Control Bezel
	122 6810	125V Indicator Lamp	11	128 6845	Stop Button - Red
	122 6800	Indicator Lamp Lens (Clear)	12	128 8358	Fan Control Bezel
3	121 6807	ON-OFF-ON Toggle Switch (DPDT)	13	128 6844	Start Button - Black
4	124 6848	8 Amp. Circuit Breaker (SCR Drive)	14	124 6843	Hole Plug - 3/8"
5	128 8354	Hopper Low Level Warning Decal	15	128 6830	Hole Plug - 7/16"
6	121 6815	ON-OFF Toggle Switch (SPST)	16	128 6927	Hole Plug - 9/16"
7	122 6814	Ignition Reset (0.1 Amp.)	17	124 1020	SCR Drive Potentiometer (10 turn-w/wire)
8	124 6838	SCR Drive Potentiometer		124 6892	Multi-Dial
	124 6849	Vernier Dial	18	124 6895	ON-OFF-ON Toggle Switch (3PDT)
	124 6839	Knob	19	121 6806	ON-OFF-ON Toggle Switch (SPDT)
			20	124 6894	Moisture Control Potentiometer w/Knob and Wire
				124 6923	Knob

Thermometer

(Model 970 Below S/N 47164)

Ref.	Part No.	Qty.	Description
1	121 8321	1	Thermometer "Lower" Decal
2	121 8322	1	Thermometer "Upper" Decal
3	121 8973	2	Thermometer - Surface Mt. 6' Capillary
—	121 2883	2	Sensing Bulb Brkt.
—	121 2882	2	Sensing Bulb Clip

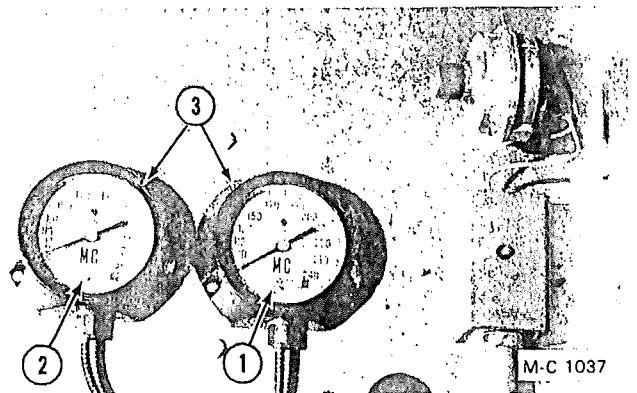

M-C 1037

This page intentionally blank.

Hopper and Level Auger

(Below S/N 48981)

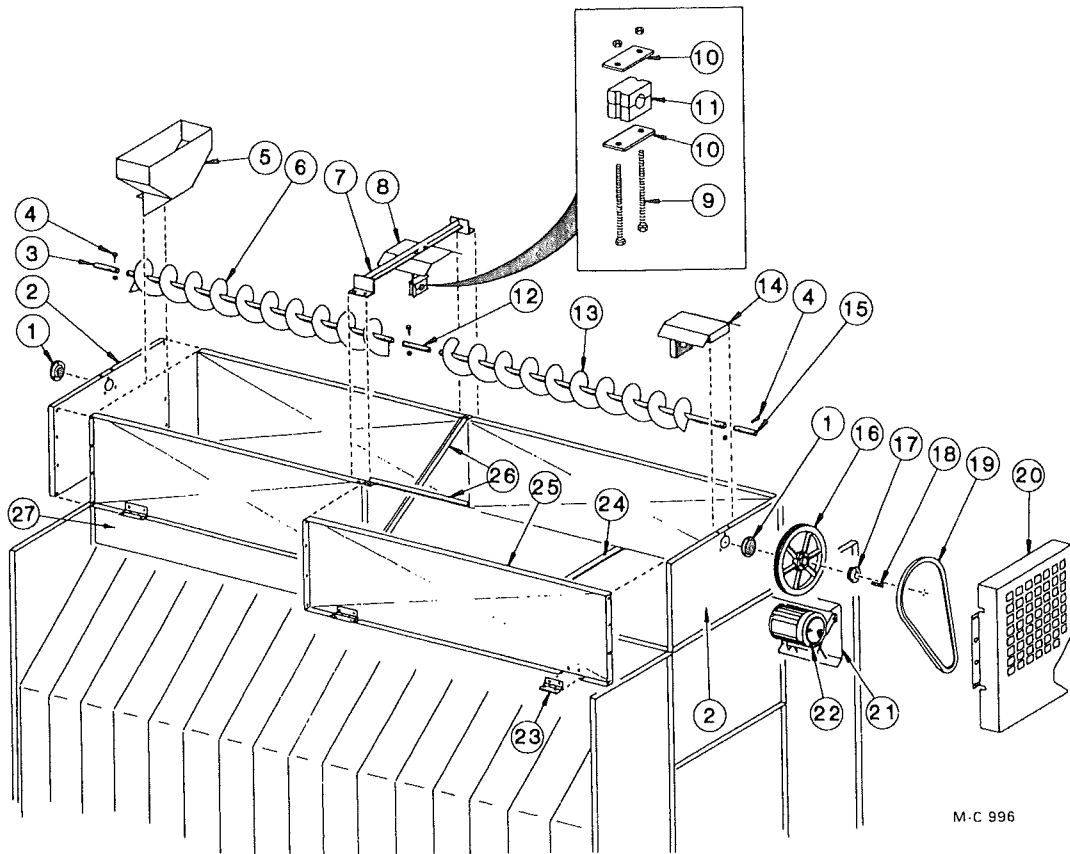

M-C 996

Ref. Part No.	Qty. 670	Qty. 970	Description	Ref. Part No.	Qty. 670	Qty. 970	Description
1 001 6003	2	2	1 1/4" Bearing w/Lock Collar	11 128 6021	1	2	1 1/4" Wood Bearing
001 6004	4	4	1 1/4" Bearing Flangette	12 128 5050	1	2	Center Shaft - 1 1/4" x 10 1/4"
000 8120	6	6	3/8 - 16 x 1" Truss Hd. Capscrew	13 128 0121	1	1	Level Auger - Front (82 3/8" RH Flighting)
000 8168	6	6	3/8 - 16 Flanged Locknut	14 - - - - -	1	1	Level Switch Ass'y. (See page 42)
2 128 4875	2	2	Hopper End Panel	15 128 5051	1	1	Front Shaft - 1 1/4" x 10" w/keyway
3 128 5052	1	1	Rear Shaft - 1 1/4" x 8"	16 128 6210	1	1	3V/19.0 x 1 Grv. Sheave "SK"
4 001 8137	8	12	3/8 - 16 x 2" Capscrew - Grd. 5	17 121 6241	1	1	1 1/4" "SK" Bushing
001 8149	8	12	3/8 - 16 Two Way Locknut	18 001 5120	1	1	Key - 1/4" x 1 1/2"
5 128 0236	1	1	Receiving Hopper	19 128 6120	1	1	3V/900 Belt
6 128 0122	1	2	Level Auger - Rear & Center (93 1/2" RH Flighting)	20 128 1500	1	1	Belt Guard
7 128 0232	1	2	Bearing Support	21 - - - - -	1	1	Motor Mount (See page 45)
8 120 4876	1	2	Bearing Shield	22 - - - - -	1	1	Level Auger Motor (See page 45 thru 47)
9 128 8134	2	4	3/8 - 16 x 7" Capscrew (Full thread)	23 128 8957	8	12	Hopper Hinge
000 8174	2	4	3/8" Flatwasher	24 128 2028	2	3	Hopper Side Panel Tie Strap
001 8139	2	4	3/8" Lockwasher	25 128 4824	4	6	Hopper Side Panel
000 8162	8	16	3/8 - 16 Hex Nut	26 128 2662	2	4	Hopper Cross Angle
10 128 3415	2	4	Hanger Bearing Bar	27 128 2934	4	6	Hopper Joiner Panel

Hopper and Level Auger

(S/N 48981 and Up)

NOTE: Two types of level auger bearing mounting were used. Service parts for the old mounting are available. However, if the complete assembly is to be replaced order kit 122 1008 (Ref. 40).

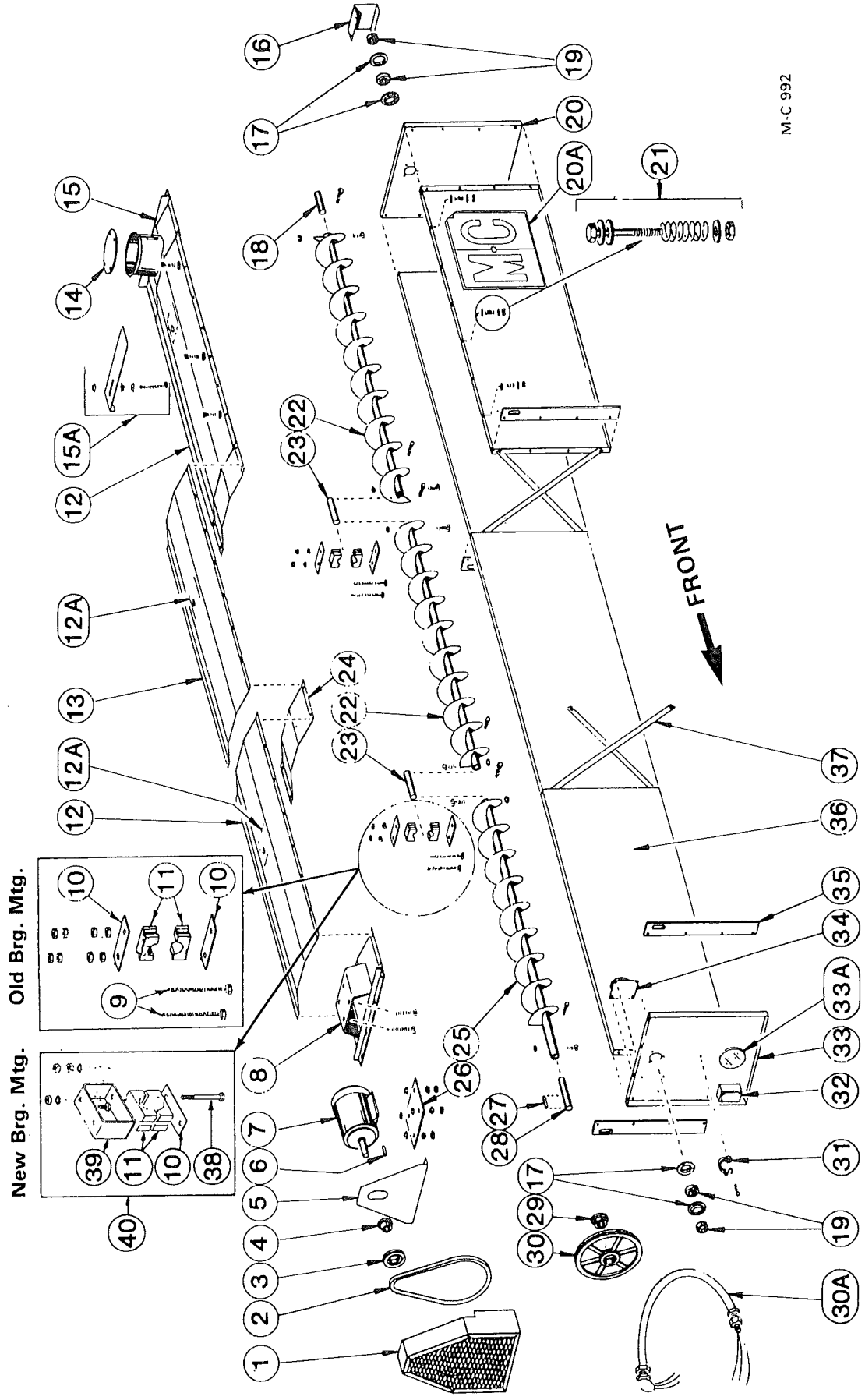

M-C 992

Hopper and Level Auger

(S/N 48981 and Up)

Ref.	Part No.	Qty. (16')	Qty. (24')	Description
1	129 0003	1	1	Level Auger Guard
2	-----	---	---	Level Auger Belt
	128 6104	1	---	3V/710 Single Belt
	128 6103	---	1	2/3V/710 (banded belt) or 128 6104 in matched set of two
3	-----	---	---	Level Auger Motor Sheave "SH"
	128 6209	1	---	3V/3.65 x 1 Grv.
	128 6207	---	1	3V/3.65 x 2 Grv.
4	-----	---	---	Level Auger Motor Bushing (See note)
	123 6222	1	---	7/8" SH Bushing - For 2 HP motor (Incl. capscrew & lockwashers)
	128 6214	---	1	1 1/8" SH Bushing - For 3 HP motor (Incl. capscrews & lockwashers)
5	129 4944	1	1	Level Auger Guard Back
6	001 5112	1	---	Key-3/16" x 1 3/8" (1.5 HP motor)
	001 5114	1	1	Key-3/16" x 1 1/2" (2 HP motor)
	001 5119	---	1	Key-1/4" x 2" (3 HP motor)
7	-----	---	1	Level Auger Motor (See pg. 45-47)
8	129 0001	1	1	Level Auger Motor Mt.
9	128 8134	2	4	3/8-16 x 7" Capscrew (Full thread)
	000 8162	8	16	3/8-16 Hex Nut
NOTE: Early production dryers were equipped as follows:				
A. 16' dryers w/1 1/2 HP level auger motor used 128 6230 3/8" SH bushing.				
B. 24' dryers w/2 HP level auger motor used 123 6222 7/8" SH bushing.				

Ref.	Part No.	Qty. (16')	Qty. (24')	Description
10	128 3415	2	4	Bearing Hanger Bar
11	128 6021	1	2	Wood Bearing - 1 1/4" (2 halves)
12	129 2945	2	2	Hopper Cover - Front & Rear (76")
12A	128 8355	2	3	Warning Decal
13	129 2946	---	1	Hopper Cover - Center (83")
14	129 4204	1	1	Receiving Tube Cover
15	129 0002	1	1	Receiving Hopper
15A	129 4205	1	1	Flow Restrictor
	129 5703	1	1	Position & Locking Bolt
	000 8168	3	3	3/8-16 Flanged Locknut
16	129 4947	1	1	Stub Guard
17	001 6004	4	4	Bearing Flangette 1 1/4"
18	128 5052	1	1	Level Auger Rear Shaft (1 1/4" x 8")
19	001 6003	2	2	Bearing w/Lock Collar - 1 1/4"
20	129 4939	1	1	Upper End Panel - Rear
20A	121 8343	2	2	M-C Decal (26 1/2" x 23")
21	000 8101	12	18	1/4-20 x 2" Capscrew
	131 8708	12	18	Spring (5/8" OD x 1 3/4")
	000 8172	36	54	1/4" Flatwasher
	000 8210	12	18	1/4-20 Two-Way Locknut
22	128 0122	1	2	Level Auger (93 1/2" RH flighting)
23	128 5050	1	2	Level Auger Center Shaft (1 1/4" x 10 1/4")
24	129 0000	1	2	Level Auger Support
25	128 0121	1	1	Level Auger (82 3/8" RH flighting)
26	129 4202	1	1	Level Auger Motor Mt. Plate
	000 8161	4	4	1/2-13 x 3 1/2" Capscrew (Full thread)
	000 8170	4	4	1/2-13 Flanged Locknut
	000 8163	8	8	1/2-13 Hex Nut

Hopper and Level Auger

(S/N 48981 and Up)

NOTE: Two types of level auger bearing mounting were used. Service parts for the old mounting are available. However, if the complete assembly is to be replaced order kit 122 1008 (Ref. 40).

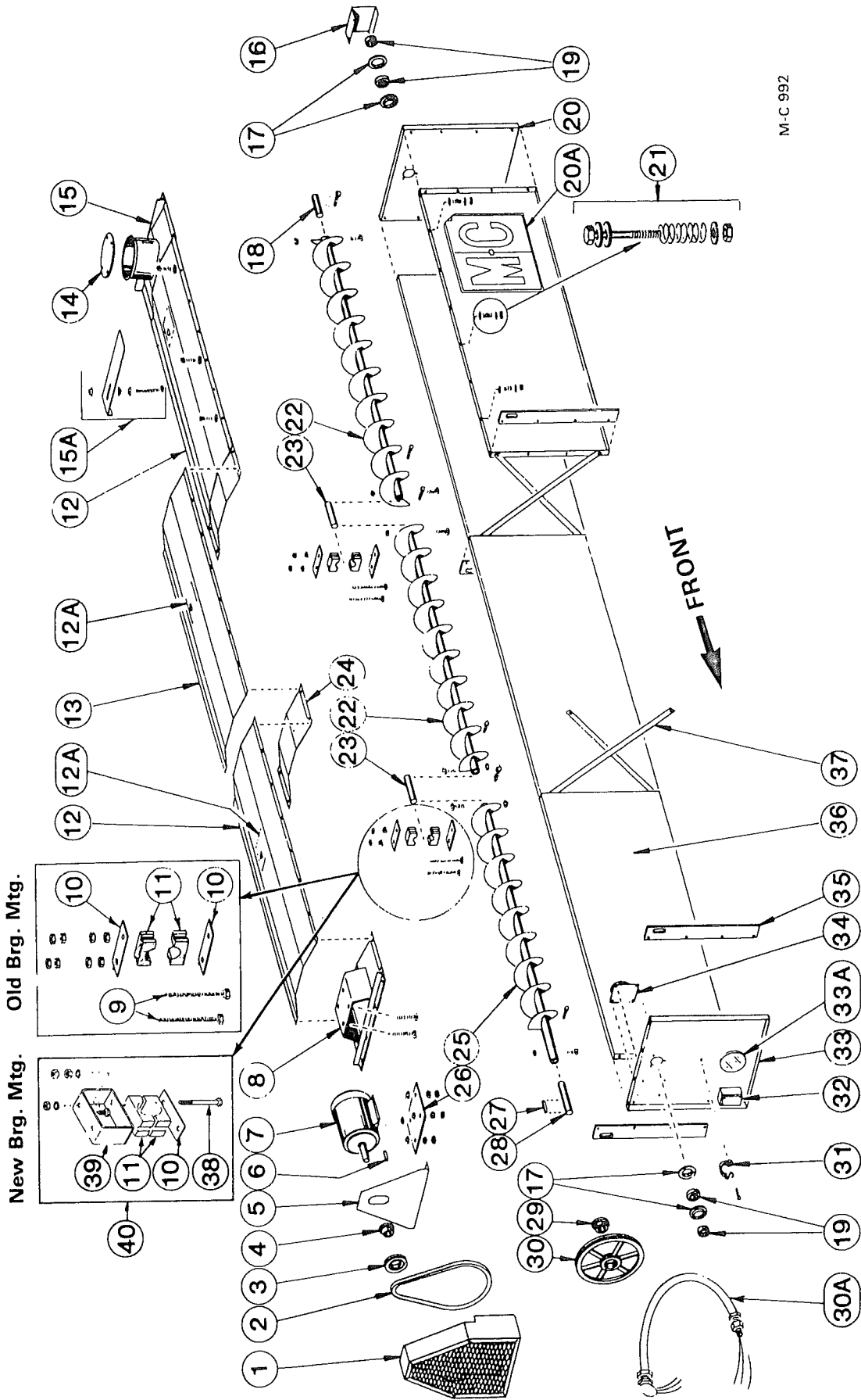

M-C 992

Hopper and Level Auger (S/N 48981 and Up)

Ref.	Part No.	Qty. (16')	Qty. (24')	Description
27	001 5120	1	1	Key- $\frac{1}{4}$ " x 1 $\frac{1}{2}$ "
28	128 5051	1	1	Level Auger Front Shaft (1 $\frac{1}{4}$ " x 10")
29	121 6241	1	1	1 $\frac{1}{4}$ " SK Bushing (Incl. capscrews & lockwashers)
30	-----	---	---	Level Auger Sheave "SK"
	128 6210	1	---	3V/19.0 x 1 Grv.
	128 6208	---	1	3V/19.0 x 2 Grv.
30A	128 1960	1	1	Flexible Conduit w/Wires
31	128 8951	1	1	Rubber Strap w/Hook
32	128 6922	1	1	Slatter Box ($\frac{1}{2}$ ")
33	129 4941	1	1	Upper End Panel - Front
33A	129 5702	1	1	Port View Lens
34	128 6992	1	1	Bin Level Indicator (See pg. 42)
35	129 3412	4	4	Lifting Bar
36	129 4943	4	6	Hopper Side
37	129 2948	2	4	Cross Strap (37")
38	001 8287	2	4	$\frac{3}{8}$ -16 x 3 $\frac{3}{4}$ " Capscrew - Grd. 5
	001 8139	2	4	$\frac{3}{8}$ " Lockwasher
	000 8162	4	8	$\frac{3}{8}$ -16 Hex Nut
39	128 0292	1	2	Level Auger Brg. Support
	001 8135	2	4	$\frac{3}{8}$ -16 x 1" Capscrew - Grd. 5
	001 8139	2	4	$\frac{3}{8}$ " Lockwasher
	000 8162	2	4	$\frac{3}{8}$ -16 Hex Nut
40	122 1008	1	2	Level Auger Brg. Kit

(Incl. ref. 10, 11, 38 & 39 in quantities reqd. for one brg.)

Level Switch Assembly

(Below S/N 48981)

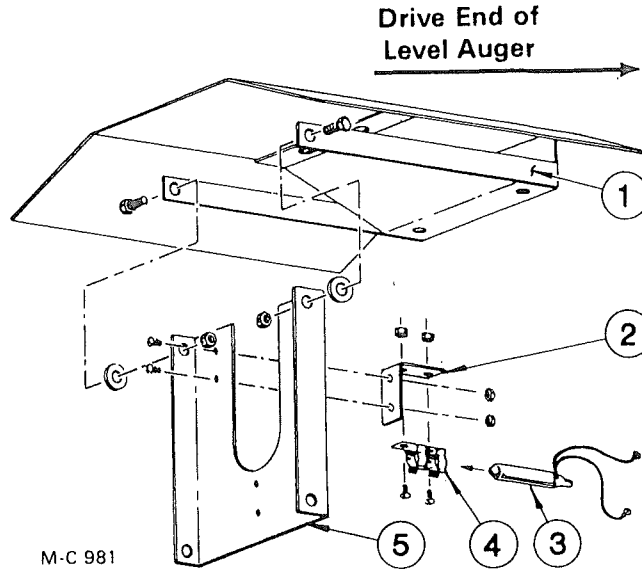

Ref.	Part No.	Qty.	Description	Ref.	Part No.	Qty.	Description
1	128 0235	1	Level Switch Cover	3	120 6800	1	Level Switch
	000 8119	2	$\frac{3}{8}$ " - 16 x $\frac{3}{4}$ " Capscrew	4	120 6801	1	Level Switch Mtg. Clip
	000 8174	4	$\frac{3}{8}$ " Flatwasher		000 8194	2	8 - 32 x $\frac{1}{2}$ " Slt'd. Bolt
	001 8149	2	$\frac{3}{8}$ " - 16 Two-Way Locknut		000 8188	2	8 - 32 Hex Nut
2	125 2902	1	Level Switch Clip	5	125 4475	1	Level Switch Trip Arm
	000 8194	2	8 - 32 x $\frac{1}{2}$ " Slt'd. Bolt				
	000 8188	2	8 - 32 Hex Nut				

Level Switch Assembly

(S/N 48981 and Up)

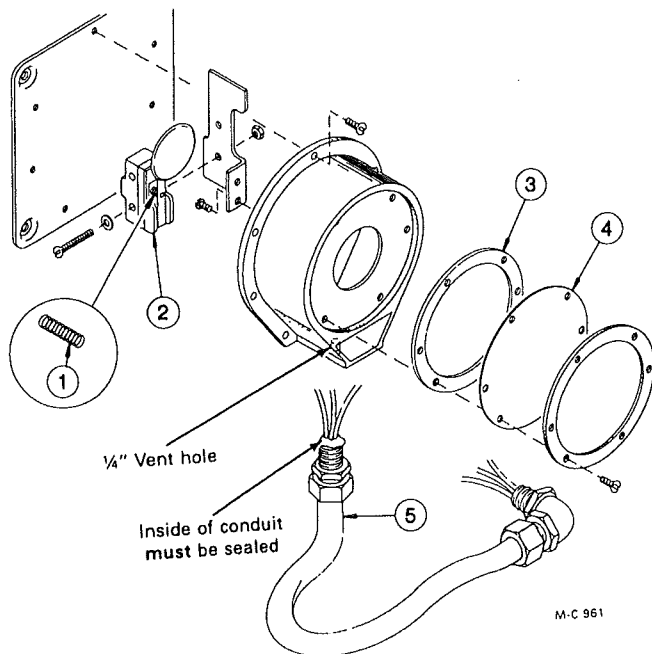

Ref.	Part No.	Qty.	Description
—	128 6992	1	Bin Level Indicator (Less ref. 5)
1	122 6847	1	Spring
2	122 6848	1	Microswitch Ass'y.
3	122 6850	1	Gasket
4	122 6849	1	Diaphragm (Teflon)
5	128 1995	1	Level Switch Wire Ass'y.

Air Pressure, High Limit and Moisture Control Switches

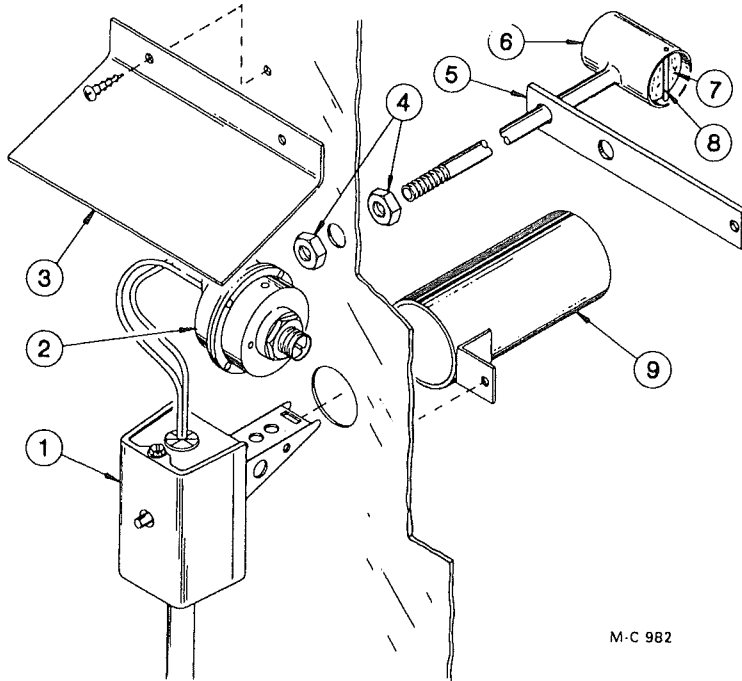

M-C 982

Air Pressure and High Limit Switches

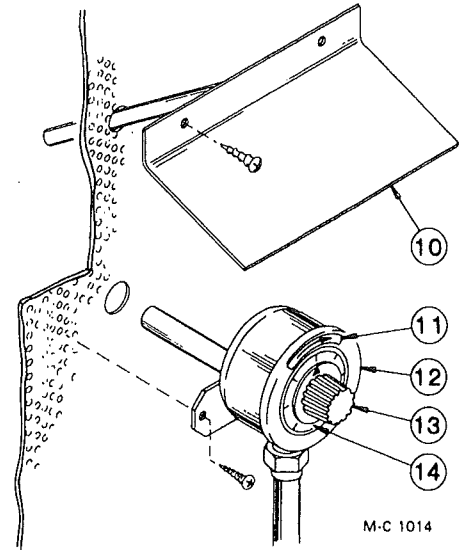

M-C 1014

Moisture Control Below S/N 51559

Ref.	Part No.	Description
1	121 7018	High Limit Switch
2	121 6849	Air Pressure Switch
3	121 2946	High Limit Switch Cover
4	121 8000	Pipe Locknut - 1/4"
5	121 2007	Air Pressure Tube Brkt.
6	121 0169	Air Pressure Tube
7	121 5716	Air Pressure Tube Filter
8	---	Filter Retainer (Wire)
9	---	Not Used
10	121 0031	Moisture Control Shield
11	121 8319	"Dry" Decal
12	121 6963	Moisture Control (Dual range)
13	122 8986	Knob
14	122 7000	Dial Plate
15	121 6915	Locknut - 1/2"
16	128 3007	Bracket
17	124 6893	Thermistor Sensor (Probe)
18	123 8089	1/2" Handy EII
19	125 6908	18/2 PVC Cord w/Shield

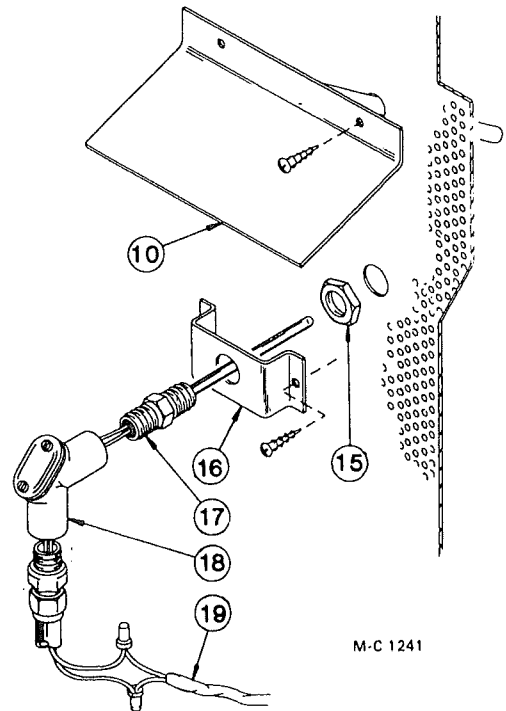

M-C 1241

Moisture Control Above S/N 51558

This page intentionally blank.

Level and Unload Auger Motor Application Chart

(Numbers represent horsepower of each motor)

Below S/N 48981

Model	670	970
Level Auger Motors (Single & Three Phase)	1.5	2

Unload Auger Motors (Single & Three Phase)	1.5	1.5
---	-----	-----

Serial No. 48981 and Up

Model	670	690	970
Level Auger Motors (Single & Three Phase)	†2	2	□3

Unload Auger Motors (Three Phase)	1.5	1.5	2
--------------------------------------	-----	-----	---

Unload Auger Motors (Single Phase)	1.5	1.5	1.5
---------------------------------------	-----	-----	-----

† - Early Production - 1 ½HP Used
 □ - Early Production - 2HP Used

Fan Motor Application Chart

Fan Motors Top To Bottom

(Numbers represent horsepower of each motor)

Single and Three Phase

Model	670	690	970
	10	---	20
	7.5	20	*

* - 15HP Used - Below S/N 47164
 10HP Used - S/N 47164 and Up

Level Auger Motor Mount

(Below S/N 48981)

Ref.	Part No.	Qty.	Description
1	128 6209	1	3V/3.65 x 1 Grv. Sheave "SH"
2	128 6230	1	5/8" SH Bushing
3	001 5112	1	Key - 3/16" x 1 3/8" (1.5 HP motor)
	001 5114	1	Key - 3/16" x 1 5/8" (2 HP motor)
4	---	1	Level Auger Motor (See page 39 thru 41)
5	120 4438	1	Motor Mount
6	120 3404	1	Hinge Bracket
	000 8119	2	3/8 - 16 x 3/4" Capscrew
	000 8168	2	3/8 - 16 Flanged Locknut
7	021 4427	1	Motor Mount Plate
8	021 3930	1	Motor Mount Brace

Ref.	Part No.	Qty.	Description
9	120 5002	1	Hinge Pin
10	000 8199	4	1/8" x 1" Cotter Pin
11	128 8955	2	Adjusting Rod
	000 8163	4	1/2 - 13 Hex Nut

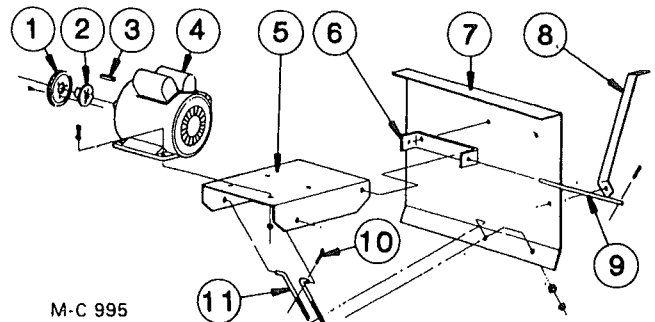

Dryer Motors, Circuit Breakers and Magnetic Starters

MOTOR			CIRCUIT BREAKER			MAGNETIC STARTER			
HP	*FLA	Part No.	Part No.	Amps.	Sq. "D" No.	Starter Part No.	Sq. "D" No.	Thermal Unit Part No.	Thermal Unit Size

200/208 V - 3 Phase - 60 HZ

□1.5	5.98	127 6833	128 6882	15	QOU 315	124 6880	KO 43	128 6947	B 9.10
‡1.5	5.98	127 6861	128 6882	15	QOU 315	124 6880	KO 43	128 6947	B 9.10
2	7.82	127 6841	128 6882	15	QOU 315	124 6880	KO 43	128 6863	B 11.5
3	11.0	127 6832	124 6875	20	QOU 320	124 6880	KO 43	128 6823	B 17.5
7.5	25.3	127 6858	124 6904	50	QOU 350	128 6976	MO 33	128 6979	B 40
10	32.2	203 6809	125 6912	60	QOU 360	128 6976	MO 33	128 6950	B 50
15	48.3	127 6854	128 6885	90	QOU 390	128 6976	MO 33	128 6953	B 79
20	62.1	127 6853	128 6966	100	QOU 3100	122 1005	PO 33	128 6827	CC 87.7

230 V - 1 Phase - 60 HZ

□1.5	8.3	121 6846	128 6878	20	QOU 220	124 6880	KO 43	128 6863	B 11.5
‡1.5	10.6	127 6863	128 6878	20	QOU 220	124 6880	KO 43	120 6850	B15.5
2	12.3	121 6862	124 6903	25	QOU 225	124 6880	KO 43	128 6949	B 19.5
3	20.0	128 6829	124 6909	40	QOU 240	124 6880	KO 43	120 6857	B 32
†7.5	38.5	124 6816	124 6908	80	QOU 280	128 6976	MO 33	124 6910	B 66
‡7.5	38.5	124 6888	124 6908	80	QOU 280	128 6976	MO 33	124 6910	B 66
10	45.0	124 6818	128 6881	90	QOU 290	128 6976	MO 33	128 6953	B 79
20	92.0	124 6879	124 6881	125	Q2L 2125	124 1018	*QO 3	128 6820	CC 156

230 V - 3 Phase - 60 HZ

□1.5	5.0	121 6845	128 6882	15	QOU 315	124 6880	KO 43	120 6851	B 7.70
‡1.5	5.0	127 6860	128 6882	15	QOU 315	124 6880	KO 43	120 6851	B 7.70
2	6.0	121 6861	128 6882	15	QOU 315	124 6880	KO 43	128 6947	B 9.10
3	9.0	128 6818	128 6882	15	QOU 315	124 6880	KO 43	125 6931	B 14.0
7.5	20.6	121 6948	128 6968	40	QOU 340	124 6880	KO 43	128 6946	B 36
10	27.2	201 6818	125 6912	60	QOU 360	128 6976	MO 33	120 6853	B 45
15	39.2	201 6819	128 6891	80	QOU 380	128 6976	MO 33	128 6978	B 70
20	49.6	125 6934	128 6885	90	QOU 390	122 1005	PO 33	128 6972	CC 74.6

460 V - 3 Phase - 60 HZ

□1.5	2.5	121 6845	128 6931	15	FAL 36015	124 6880	KO 43	128 6984	B 3.00
‡1.5	2.5	127 6860	128 6931	15	FAL 36015	124 6880	KO 43	128 6984	B 3.00
2	3.0	121 6861	128 6931	15	FAL 36015	124 6880	KO 43	128 6948	B 4.15
3	4.5	128 6818	128 6931	15	FAL 36015	124 6880	KO 43	120 6845	B 6.9
7.5	10.3	121 6948	128 6933	20	FAL 36020	124 6880	KO 43	128 6823	B 17.5
10	13.6	201 6818	125 6928	30	FAL 36030	124 6880	KO 43	120 6855	B 25.0
15	19.6	201 6819	128 6930	40	FAL 36040	128 6976	MO 33	128 6946	B 36
20	24.8	125 6934	128 6937	60	FAL 36060	128 6976	MO 33	120 6853	B 45

575 V - 3 Phase - 60 HZ

□1.5	2	127 6815	128 6931	15	FAL 36015	124 6880	KO 43	128 6984	B 3.00
‡1.5	2	127 6862	128 6931	15	FAL 36015	124 6880	KO 43	128 6984	B 3.00
2	2.4	127 6816	128 6931	15	FAL 36015	124 6880	KO 43	120 6848	B 3.70
3	3.6	127 6814	128 6931	15	FAL 36015	124 6880	KO 43	120 6829	B 5.50
7.5	8.2	127 6828	128 6931	15	FAL 36015	124 6880	KO 43	128 6863	B 11.5
10	10.8	127 6857	128 6933	20	FAL 36020	124 6880	KO 43	128 6823	B 17.5
15	15.6	127 6845	125 6928	30	FAL 36030	124 6880	KO 43	128 6971	B 28
20	19.8	127 6844	128 6930	40	FAL 36040	124 6880	KO 43	128 6946	B 36

* If FLA (Full Load Amps) shown does not match FLA imprinted on motor name plate, refer to Square D charts for correct thermal unit size.

□ - 5/8" Shaft ‡ - 7/8" Shaft

† 124 6816 has 1 3/8" shaft. 124 6888 has 1 1/8" shaft.

* 121 6876 (SEO-1) used on early production.

115V Coils and Interlocks

Starter		Coil		Interlock	
Sq. "D" No.	M-C No.	M-C No.	Sq. "D" No.	M-C No.	Sq. "D" No.
SEO-1	**121 6876	122 6806	31074-400-38	121 6987	9999-SX-8
PO33	122 1005	122 6846	9998-DP-39	122 6851	9999-R-37
QO3	●124 1018	122 6846	9998-DP-39	122 6851	9999-R-37
KO43	124 6880	122 6832	9998-DPM-40	128 6980	9999-R-20
MO33	128 6976	122 6832	9998-DPM-40	128 6980	9999-R-20

Jumper Strap Kits and Contact Kits

Starter		Jumper Strap Kit (2 straps per kit)		Contact Kit	
Sq. D No.	M-C No.	M-C No.	Sq. "D" No.	M-C No.	Sq. "D" No.
SEO-1	**121 6876	124 6885	9998-SO32	122 6858	9998-SL3
PO33	122 1005	-----	-----	122 6856	9998-LA73
QO3	●124 1018	124 6885	9998-SO32	122 6857	9998-LA93
KO43(60HZ)	124 6880	120 6841	9998-SO31	122 6855	9998-LA38
MO33(60HZ)	128 6976	120 6841	9998-SO31	122 6854	9998-LA57

** Early Production ● Late Production

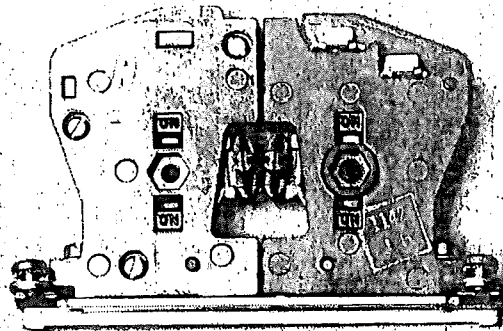

Interlock 121 6987 (Type SX-8)

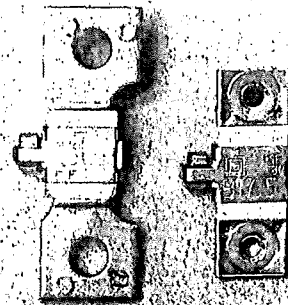

Thermal Units

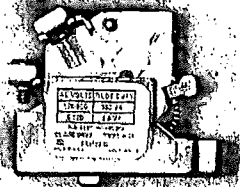

Interlock
122 6851
(Type R-37)



Interlock
128 6980
(Type R-20)

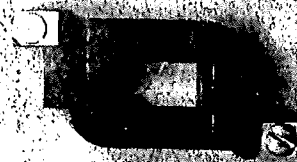

Magnetic Starter
115V Coil

M-C 830

10" Unloading Auger Extension Kit (2') - 127 1181

(S/N 47164 and Up)

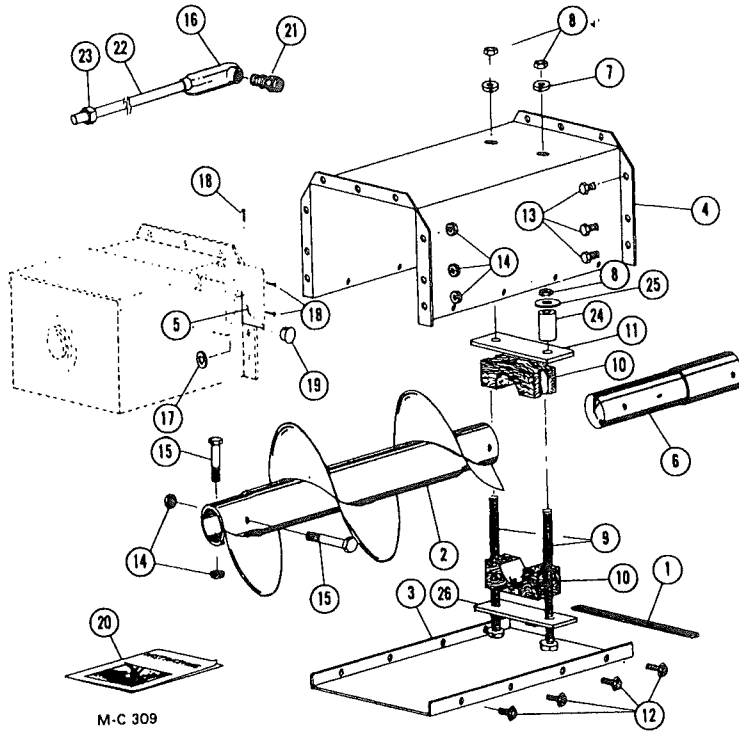

Old Bearing Mounting

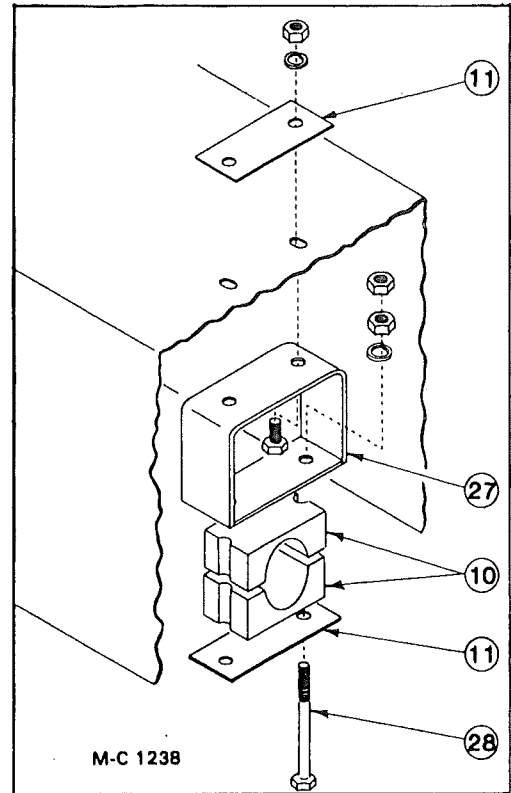

New Bearing Mounting

NOTE: Two types of bearing mounting were used. Order bearing mounting parts as required. Kit 127 1181 includes new bearing mounting parts.

Ref.	Part No.	Qty.	Description	Ref.	Part No.	Qty.	Description
1	121 8957	1	Rubber Guard Edge	19	121 8600	1	½" Knock-Out Plug
2	127 0029	1	Unload Auger Extension	20	D151	1	Installation Instructions
3	127 4436	1	Auger Cover - Bottom	21	121 6892	2	½" Straight Connector
4	127 4435	1	Unload Auger Cover	22	120 6865	1	½" Conduit (30" Long)
5	127 4786	1	Switch Cover - Back	23	121 6895	1	½" Conduit Union
6	127 5081	1	Unload Auger Link	24	128 5572	2	Spacer - 3¾"
7	000 8180	2	½" Lockwasher	25	001 8257	2	½" SAE Flatwasher
8	000 8163	4	½-13 Hex Nut	26	128 0285	1	Bearing Support
9	041 8160	2	½-13 x 8" Capscrew - Grd. 8 (Full Thread)	27	128 0288	1	Bearing Bracket
10	128 6020	1	1-15/16" Wood Bearing		133 8161	2	½-13 x 1½" Capscrew - Grd. 5
11	128 4250	2	Mid Bearing Support		000 8180	2	½" Lockwasher
12	001 8284	8	5/16-12 x ½" Self Tapping Screw		000 8163	2	½ - 13 Hex Nut
13	000 8119	9	⅜-16 x ¾" Capscrew	28	001 8168	2	½-13 x 4½" Capscrew - Grd. 5
14	000 8205	15	⅜-16 Top Lock Flange Nut		000 8180	2	½" Lockwasher
15	000 8229	6	⅜-16 x 2¾" Capscrew - Grd. 5		000 8163	4	½ - 13 Hex Nut
16	125 6915	1	½" LR 50A Condulet	—	121 6868	2	Closed End Splice
17	000 8174	1	⅜" Flatwasher	—	128 6925	2	Female Insulator
18	000 8184	3	8-18 x ½" Philips Pan Head Screw	—	121 6930	8 ft.	18 Ga. Black Wire

Portabilities (Optional)

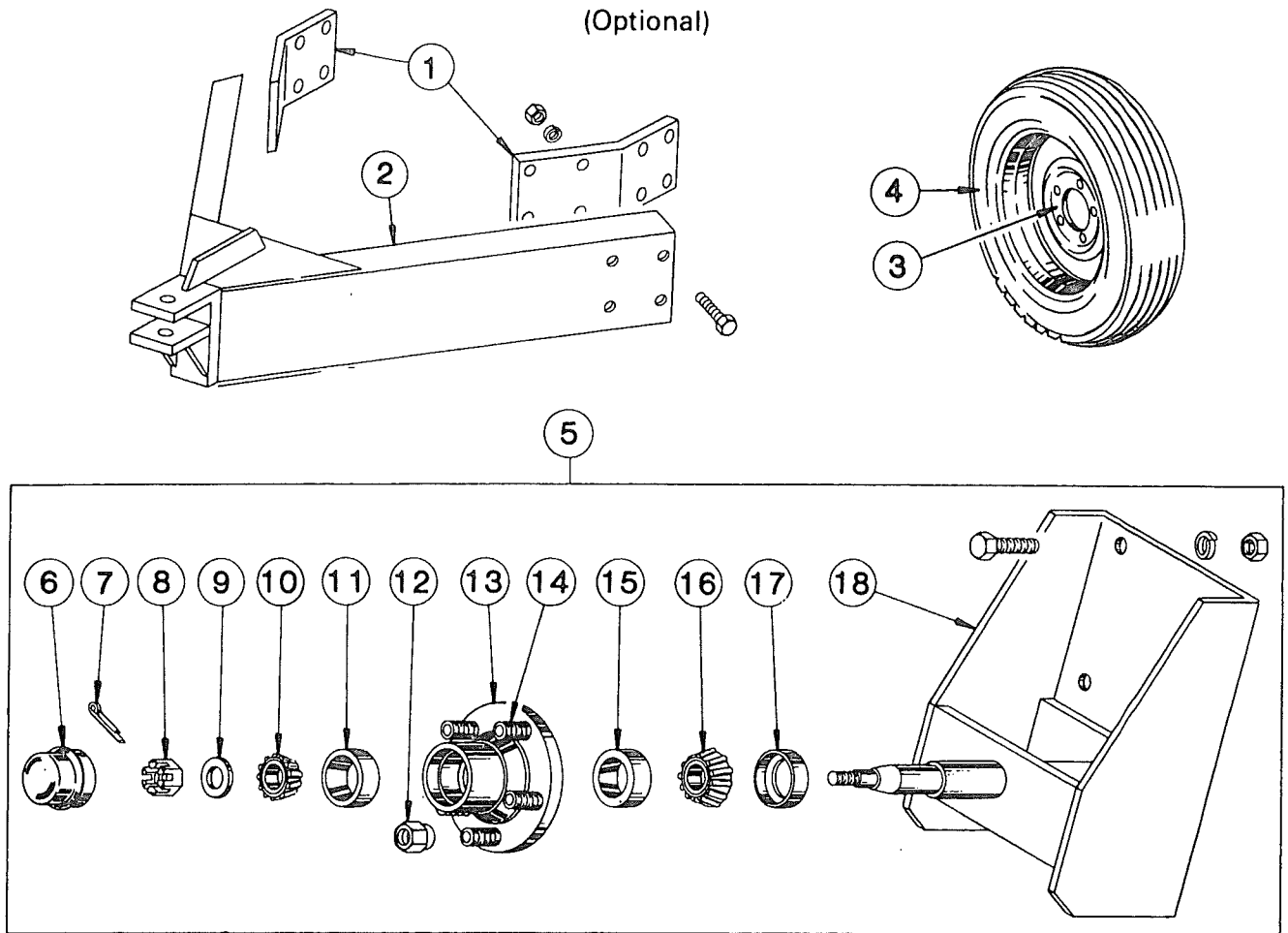

M-C 980

120 1030 - 4 Wheel Portabilities (Incl. ref. 1 & 2 and four of ref. 3 & 5 less tires)

120 1031 - 6 Wheel Portabilities (Incl. ref. 1 & 2 and six of ref. 3 & 5 less tires)

120 1043 - 8 Wheel Portabilities (Incl. ref. 1 & 2 and eight of ref. 3 & 5 less tires)

120 1040 - Additional Portabilities (Incl. two of ref. 3 & 5 less tires)

Ref.	Part No.	Qty.	Description	Ref.	Part No.	Qty.	Description
1	128 3671	2	Pole Mount Brkt.	6	001 8996	1	Hub Cap
	128 8196	8	3/4 - 10 x 2 1/2" Capscrew - Grd. 5	7	001 8252	1	Cotter Pin - 1/8" x 1"
	000 8182	8	3/4" Lockwasher	8	001 8253	1	Spindle Nut
	000 8165	8	3/4 - 10 Hex Nut	9	001 8254	1	Spindle Washer
2	120 0047	1	Dryer Pole	10	001 6000	1	Bearing Cone - Outer
	128 8195	8	3/4 - 10 x 2" Capscrew - Grd. 5	11	002 6000	1	Bearing Cup - Outer
	000 8182	8	3/4" Lockwasher	12	001 8989	5	1/2 - 20 Lug Nut - 45°
	000 8165	8	3/4 - 10 Hex Nut	13	001 8992	1	Wheel Hub Ass'y. - 5 Bolt (Incl. ref. 11, 14 & 15)
3	001 8993	1	5 Bolt Wheel - 15"	14	002 8152	5	1/2 - 20 x 1 1/2" Stud
4	127 8990	1	7.60 x 15 - 6 Ply Tubeless Tire	15	002 6001	1	Bearing Cup - Inner
5	120 1028	1	Wheel Spindle & Hub Ass'y. (Incl. ref. 6 thru 18)	16	001 6001	1	Bearing Cone - Inner
	000 8146	6	5/8 - 11 x 1 1/2" Capscrew - Grd. 5	17	001 8991	1	Seal
	000 8181	6	5/8" Lockwasher	18	120 0031	1	Wheel Mount
	000 8164	6	5/8 - 11 Hex Nut				

Kits (Field Installed)

Decal Kit - All Models (See note)
128 9017

Ignition Wire or Remote Sensing Wire Kit
122 9003

Remote Sensing Kit
128 9026

Unload Auger Extension Kit (2 ft.) - For S/N 47164 and Up
127 1181

NOTE: Kit contains all decals except dryer model decals. They must be ordered separately. See ref. 9 page 7, ref. 18 & 19 page 10 and ref. 9 & 10 page 13.

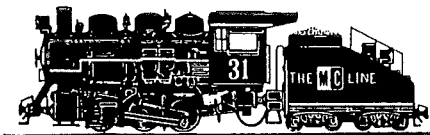

Iron Horse Quality